

# Soils Map

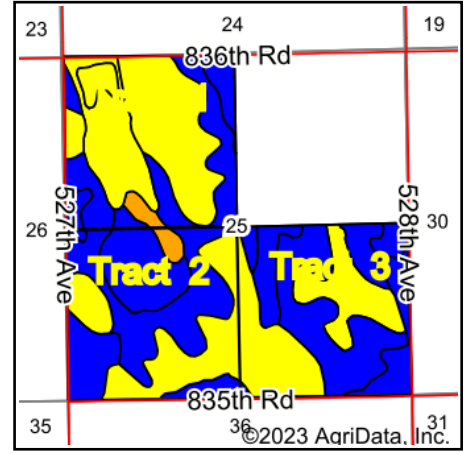

State: **Nebraska**  
 County: **Antelope**  
 Location: **25-23N-6W**  
 Township: **Cedar**  
 Acres: **478.45**  
 Date: **11/24/2023**

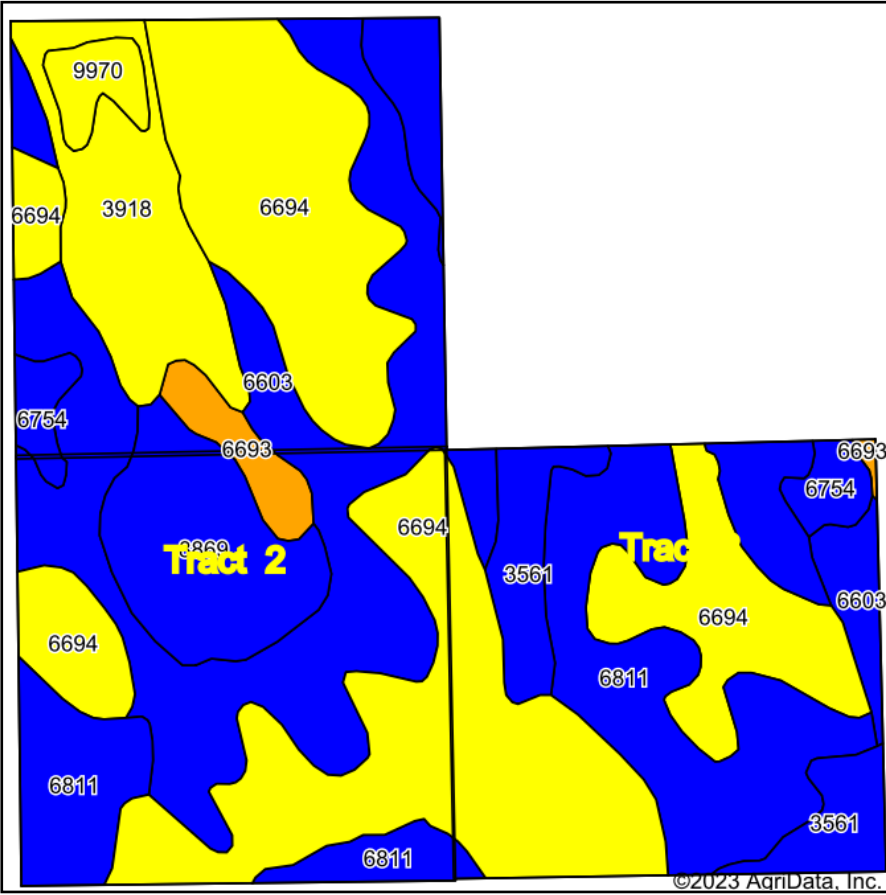

Maps Provided By:



© AgriData, Inc. 2023

www.AgriDataInc.com



Soils data provided by USDA and NRCS.

Area Symbol: NE003, Soil Area Version: 25

Code	Soil Description	Acres	Percent of field	Non-Irr Class Legend	Non-Irr Class *c	Irr Class *c	*n NCCPI Overall	*n NCCPI Corn	*n NCCPI Small Grains	*n NCCPI Soybeans
6694	Crofton-Nora complex, 6 to 11 percent slopes, eroded	176.16	36.8%		IVe	IVe	64	60	51	64
6603	Alcester silty clay loam, 2 to 6 percent slopes	99.98	20.9%		IIe	IIIe	75	74	66	72
6811	Moody silty clay loam, 2 to 6 percent slopes	82.40	17.2%		IIe	IIIe	75	74	67	74
3918	Bonesteel silt loam	34.08	7.1%		IVw	IVw	18	18	18	18
8869	Hord silt loam, cool, 0 to 2 percent slopes	31.76	6.6%		IIe	IIe	80	73	67	80
3561	Hobbs silt loam, 0 to 2 percent slopes, occasionally flooded, cool	29.46	6.2%		IIw	IIw	78	74	61	78
6754	Nora silt loam, 2 to 6 percent slopes, eroded	9.59	2.0%		IIe	IIIe	68	62	53	68
6693	Crofton-Nora complex, 2 to 6 percent slopes, eroded	8.58	1.8%		IIIe	IIIe	67	62	53	67
9970	Aquolls	6.44	1.3%		Vw					
<b>Weighted Average</b>					<b>2.94</b>	<b>*</b>	<b>*n 66.1</b>	<b>*n 63.3</b>	<b>*n 55.6</b>	<b>*n 65.3</b>

\*n: The aggregation method is "Weighted Average using all components"

\*c: Using Capabilities Class Dominant Condition Aggregation Method

\*- Irr Class weighted average cannot be calculated on the current soils data due to missing data.

Soils data provided by USDA and NRCS.