

Soils Map

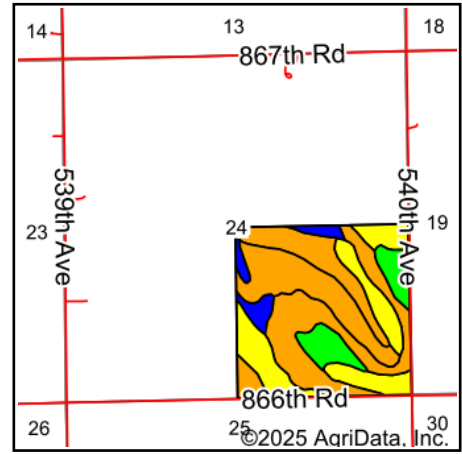

State: **Nebraska**
 County: **Pierce**
 Location: **24-28N-4W**
 Township: **North Dry Creek**
 Acres: **159.5**
 Date: **3/11/2025**

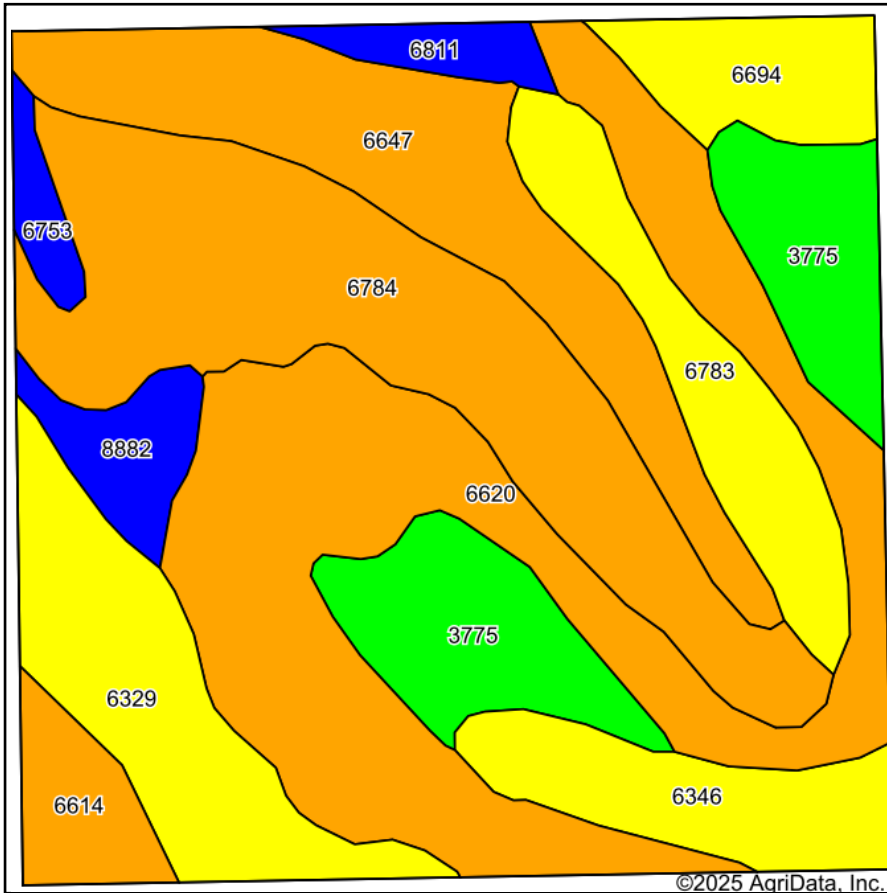

Soils data provided by USDA and NRCS.

Area Symbol: NE139, Soil Area Version: 23

Code	Soil Description	Acres	Percent of field	Non-Irr Class Legend	Non-Irr Class *c	Irr Class *c	*n NCCPI Overall	*n NCCPI Corn	*n NCCPI Small Grains	*n NCCPI Soybeans
6620	Bazile soils, 1 to 6 percent slopes	40.31	25.3%		IIIe	IIIe	50	46	50	42
6784	Nora-Thurman complex, 6 to 11 percent slopes	30.60	19.2%		IIIe	IVe	54	47	54	48
6647	Boelus-Loretto complex, 2 to 6 percent slopes	19.61	12.3%		IIIe	IIIe	56	47	56	49
3775	Muir silt loam, 0 to 2 percent slopes, rarely flooded	16.59	10.4%		Iw	Ie	88	88	71	83
6329	Lawet loam, occasionally flooded	14.04	8.8%		IVw	IVw	66	45	45	66
6783	Nora-Thurman complex, 11 to 17 percent slopes	10.53	6.6%		IVe		50	44	50	44
6346	Lawet-Saltine complex, occasionally flooded	8.86	5.6%		IVw	IVw	59	36	44	56
6694	Crofton-Nora complex, 6 to 11 percent slopes, eroded	6.23	3.9%		IVe	IVe	64	60	56	64
6614	Bazile silt loam, 1 to 6 percent slopes	4.37	2.7%		IIIe	IIIe	61	54	61	54
8882	Hord-Hobbs silt loams, 0 to 6 percent slopes	4.10	2.6%		Ile	Ile	71	62	66	71
6811	Moody silty clay loam, 2 to 6 percent slopes	2.43	1.5%		Ile	IIIe	75	74	68	74
6753	Nora silt loam, 2 to 6 percent slopes	1.83	1.1%		Ile	IIIe	75	65	63	75
Weighted Average					2.99	*-	*n 59.4	*n 51.7	*n 54.3	*n 54.1

Soils data provided by USDA and NRCS.

Maps Provided By:



© AgriData, Inc. 2023

www.AgriDataInc.com

*n: The aggregation method is "Weighted Average using all components"

*c: Using Capabilities Class Dominant Condition Aggregation Method

*- Irr Class weighted average cannot be calculated on the current soils data due to missing data.