

Soils Map

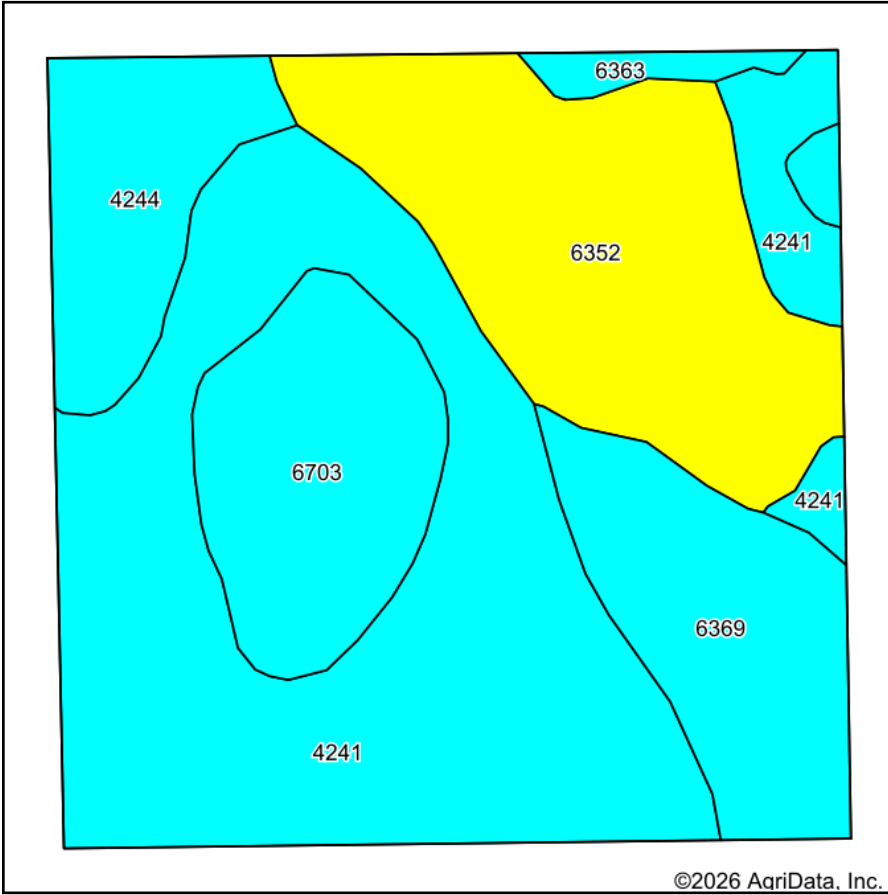

Soils data provided by USDA and NRCS.

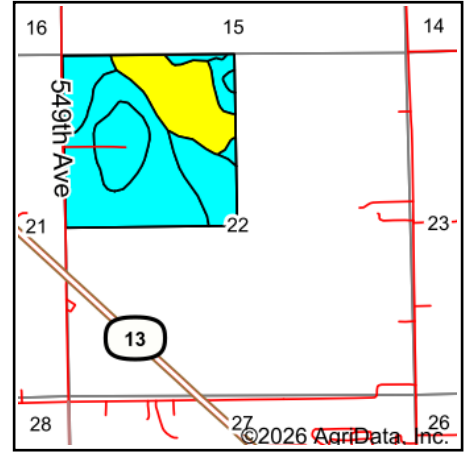

State: **Nebraska**
 County: **Pierce**
 Location: **22-26N-2W**
 Township: **Pierce**
 Acres: **159.07**
 Date: **2/3/2026**



Maps Provided By:



Area Symbol: NE139, Soil Area Version: 24

Code	Soil Description	Acres	Percent of field	SRPG Legend	Non-Irr Class *c	Irr Class *c	SRPG	*n NCCPI Overall	*n NCCPI Corn	*n NCCPI Small Grains	*n NCCPI Soybeans
4241	Ord fine sandy loam, occasionally flooded	68.67	43.3%		IIw	IIw	38	41	39	41	41
6352	Leshara silt loam, occasionally flooded	35.33	22.2%		IIw	IIw	63	68	55	58	68
6369	Orwet loam, rarely flooded	19.30	12.1%		IVw		21	34	32	32	34
6703	Thurman loamy fine sand, 2 to 6 percent slopes	19.09	12.0%		IVe	IVe	32	51	51	41	34
4244	Ord loam, occasionally flooded	13.60	8.5%		IIw	IIw	39	44	40	42	44
6363	Obert silt loam, 0 to 2 percent slopes, frequently ponded	3.08	1.9%		VIw		24	39	19	37	16
Weighted Average					2.56	*-	40.6	*n 47.6	*n 42.8	*n 43.7	*n 45.1

*n: The aggregation method is "Weighted Average using all components"

*c: Using Capabilities Class Dominant Condition Aggregation Method

*- Irr Class weighted average cannot be calculated on the current soils data due to missing data.