

Soils Map

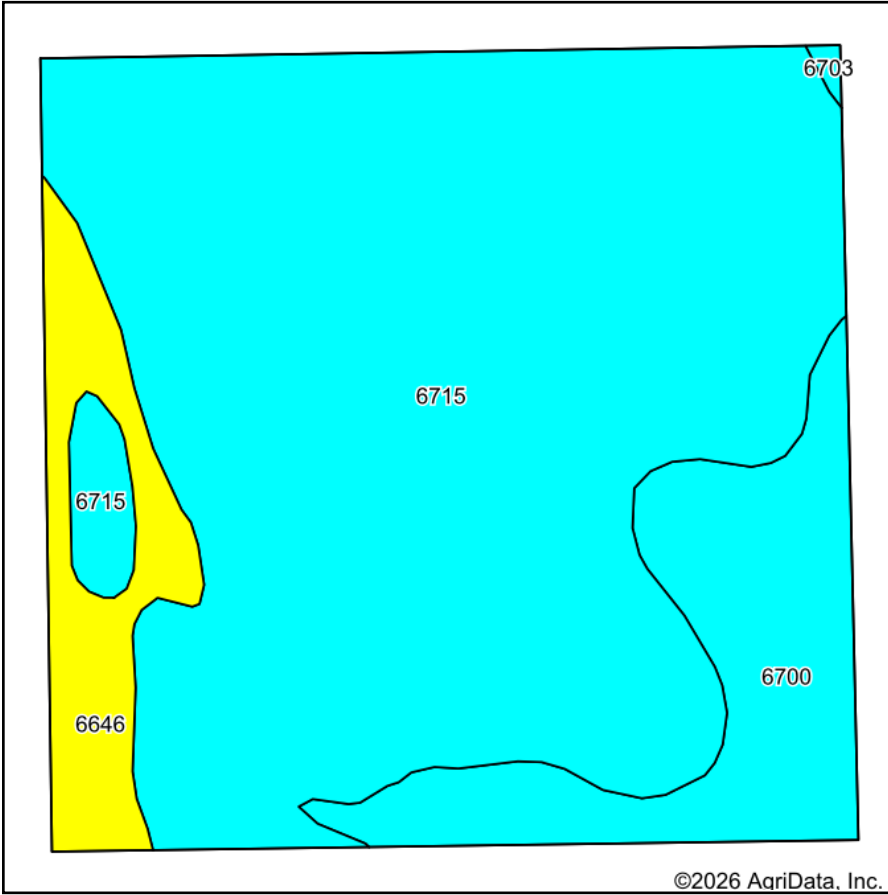

Soils data provided by USDA and NRCS.

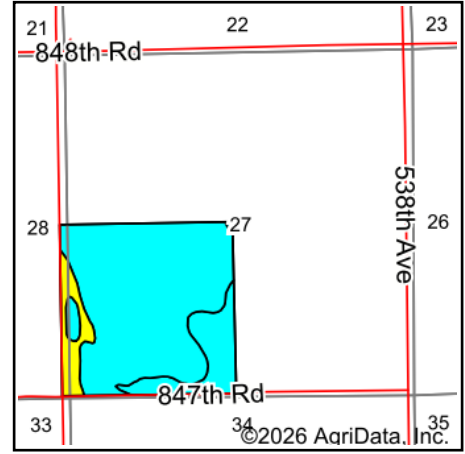

State: **Nebraska**
 County: **Pierce**
 Location: **27-25N-4W**
 Township: **Mills**
 Acres: **158.96**
 Date: **1/31/2026**



Maps Provided By:



Area Symbol: NE139, Soil Area Version: 24

Code	Soil Description	Acres	Percent of field	SRPG Legend	Non-Irr Class *c	Irr Class *c	SRPG	Grain sorghum Bu	Grain sorghum Irrigated Bu	*n NCCPI Overall	*n NCCPI Corn	*n NCCPI Small Grains	*n NCCPI Soybeans
6715	Thurman-Valentine complex, undulating	122.99	77.4%		IVe	IVe	29	25	93	33	31	33	25
6700	Thurman loamy fine sand, 0 to 2 percent slopes	23.37	14.7%		IIIe	IIIe	34			50	50	40	33
6646	Boelus-Loretto complex, 0 to 2 percent slopes	12.30	7.7%		IIIe	IIIe	63			56	48	56	51
6703	Thurman loamy fine sand, 2 to 6 percent slopes	0.30	0.2%		IVe	IVe	32			51	51	41	34
Weighted Average					3.78	3.78	32.4	19.3	72	*n 37.3	*n 35.1	*n 35.8	*n 28.2

*n: The aggregation method is "Weighted Average using all components"

*c: Using Capabilities Class Dominant Condition Aggregation Method