

# Soils Map

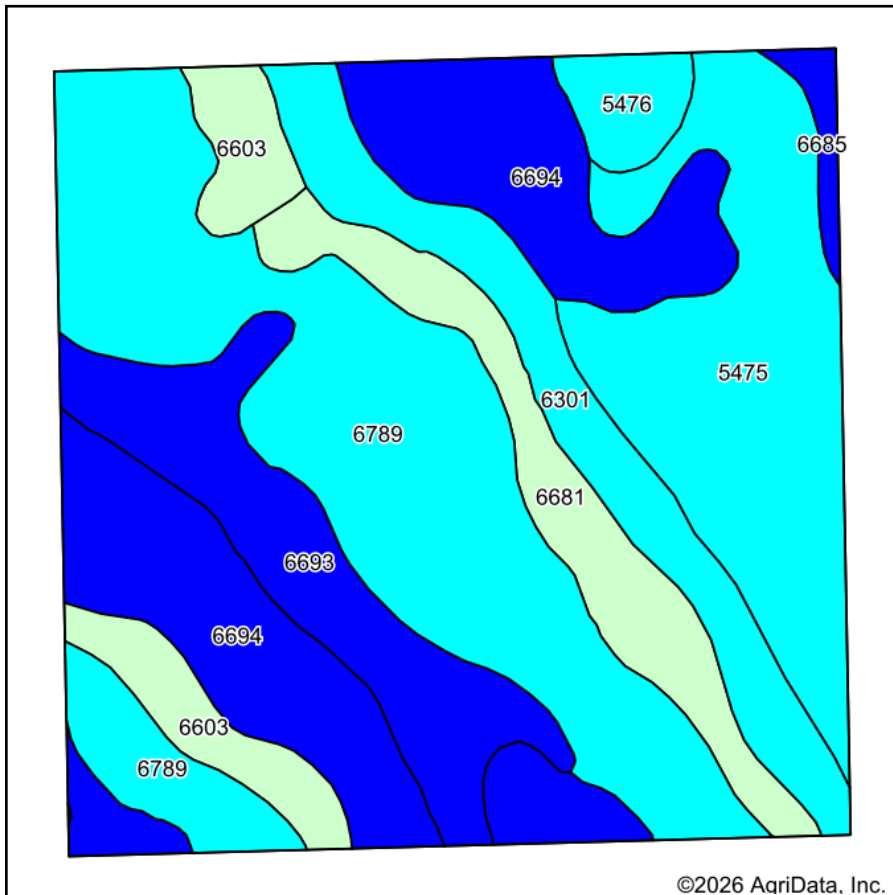

Soils data provided by USDA and NRCS.

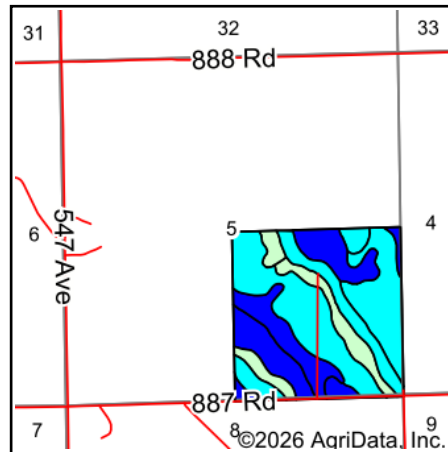

State: **Nebraska**  
 County: **Knox**  
 Location: **5-31N-2W**  
 Township: **Dolphin**  
 Acres: **159.74**  
 Date: **1/30/2026**



Maps Provided By:



© AgriData, Inc. 2025

www.AgriDataInc.com



Area Symbol: NE107, Soil Area Version: 23

Code	Soil Description	Acres	Percent of field	SRPG Legend	Non-Irr Class *c	Irr Class *c	SRPG	*n NCCPI Overall	*n NCCPI Corn	*n NCCPI Small Grains	*n NCCPI Soybeans
6789	Crofton-Nora complex, 11 to 17 percent slopes, eroded	44.53	27.9%		Vle		48	61	57	54	61
6694	Crofton-Nora complex, 6 to 11 percent slopes, eroded	32.69	20.5%		IVe	IVe	53	64	60	56	64
5475	Betts clay loam, 11 to 15 percent slopes, eroded	26.51	16.6%		Vle		33	48	33	48	43
6693	Crofton-Nora complex, 2 to 6 percent slopes, eroded	16.41	10.3%		IIIe	IIIe	58	67	62	58	67
6301	Aowa silt loam, channeled, 0 to 3 percent slopes, frequently flooded	14.19	8.9%		VIw	VIw	44	52	44	30	52
6681	Crofton silt loam, 17 to 30 percent slopes, eroded	12.20	7.6%		Vle			38	38	31	36
6603	Alcester silty clay loam, 2 to 6 percent slopes	8.48	5.3%		Ile	IIIe		75	75	66	73
5476	Betts clay loam, 15 to 30 percent slopes	3.22	2.0%		Vle		17	27	23	26	27
6685	Crofton silt loam, 2 to 6 percent slopes, eroded	1.51	0.9%		IIIe	IIIe	52	68	61	63	68
<b>Weighted Average</b>					<b>5.04</b>	<b>*-</b>	<b>40.4</b>	<b>*n 57.6</b>	<b>*n 51.8</b>	<b>*n 50.1</b>	<b>*n 56.6</b>

\*n: The aggregation method is "Weighted Average using all components"

\*c: Using Capabilities Class Dominant Condition Aggregation Method

\*- Irr Class weighted average cannot be calculated on the current soils data due to missing data.

Soils data provided by USDA and NRCS.