

# Soils Map

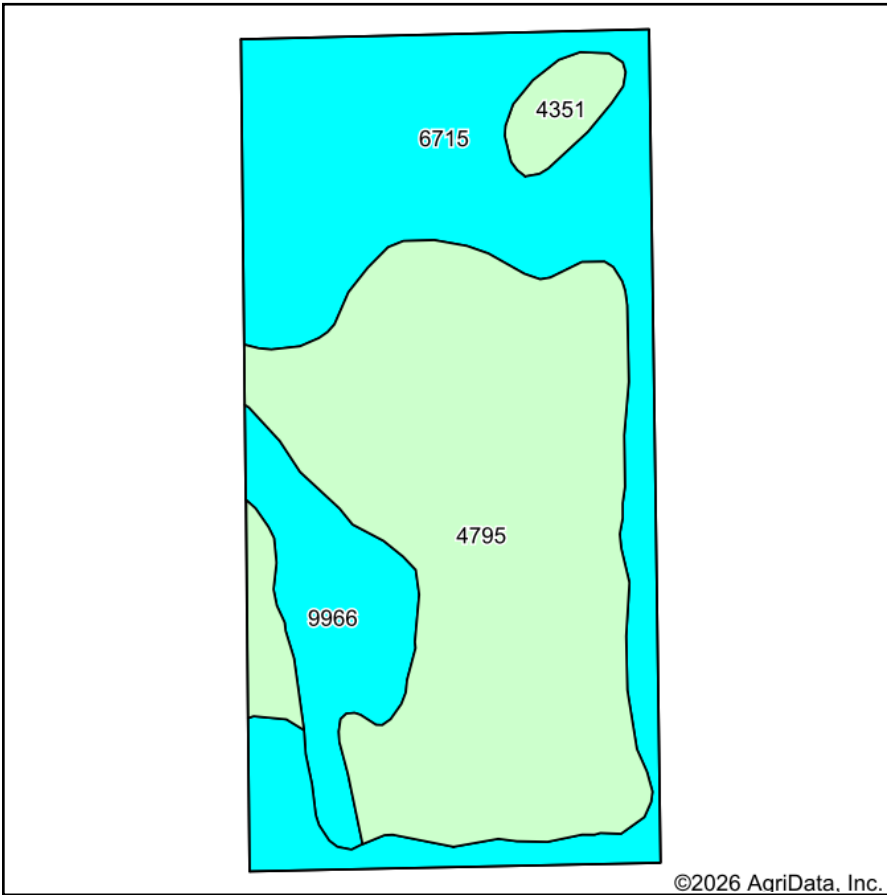

Soils data provided by USDA and NRCS.

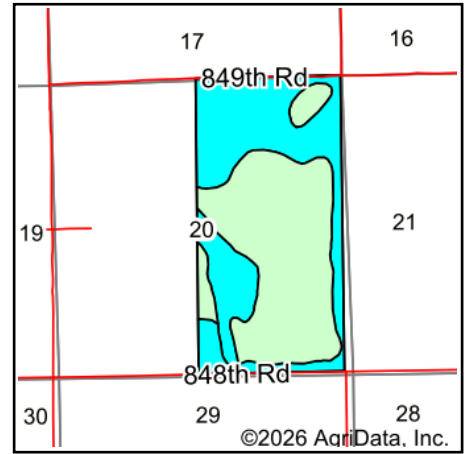

State: **Nebraska**  
 County: **Pierce**  
 Location: **20-25N-4W**  
 Township: **Mills**  
 Acres: **315.46**  
 Date: **1/17/2026**



Maps Provided By:



Area Symbol: NE139, Soil Area Version: 24

Code	Soil Description	Acres	Percent of field	SRPG Legend	Non-Irr Class *c	Irr Class *c	SRPG	Grain sorghum Bu	Grain sorghum Irrigated Bu	*n NCCPI Overall	*n NCCPI Corn	*n NCCPI Small Grains	*n NCCPI Soybeans
4795	Valentine fine sand, rolling, moist	158.96	50.4%		Vle					34	34	30	22
6715	Thurman-Valentine complex, undulating	116.24	36.8%		IVe	IVe	29	25	93	33	31	33	25
9966	Blown-out land	31.86	10.1%		VIIe		0						
4351	Elsmere loamy fine sand, 0 to 2 percent slopes, rarely flooded	8.40	2.7%		IVw	IVw		48	95	47	47	37	28
<b>Weighted Average</b>					<b>5.31</b>	<b>*-</b>	<b>10.7</b>	<b>10.5</b>	<b>36.8</b>	<b>*n 30.5</b>	<b>*n 29.8</b>	<b>*n 28.3</b>	<b>*n 21</b>

\*n: The aggregation method is "Weighted Average using all components"

\*c: Using Capabilities Class Dominant Condition Aggregation Method

\*-: Irr Class weighted average cannot be calculated on the current soils data due to missing data.