

Soils Map

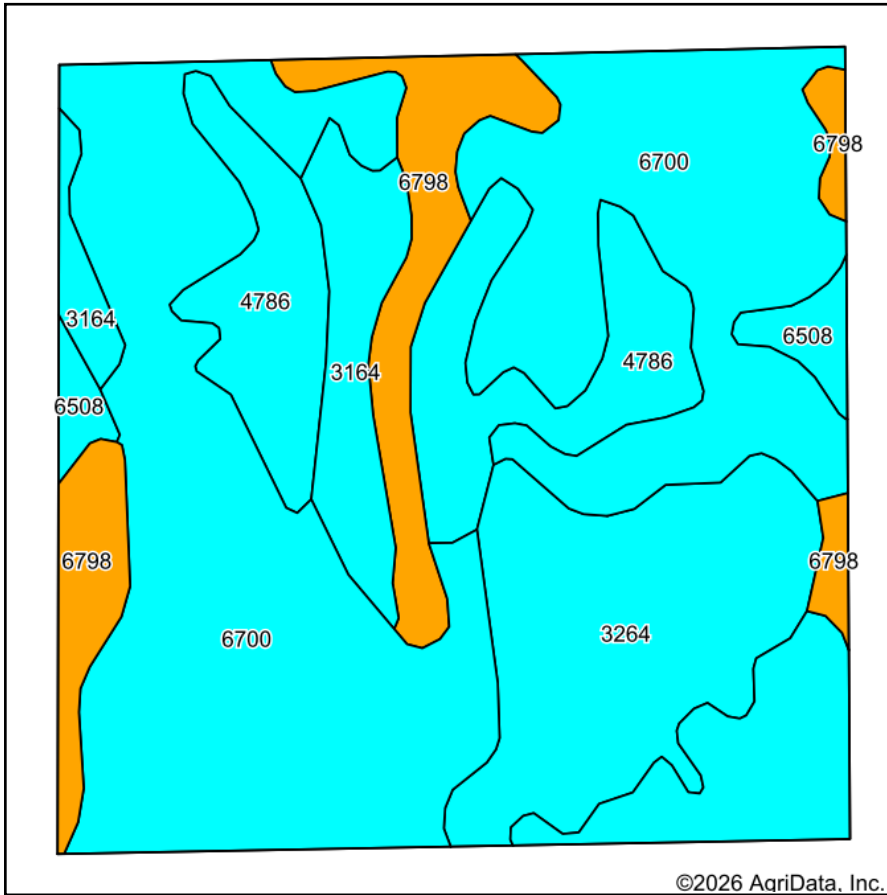

Soils data provided by USDA and NRCS.

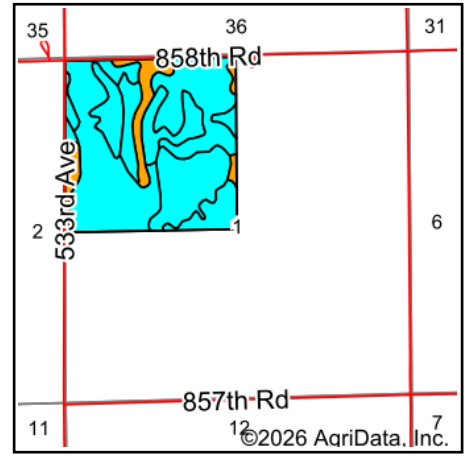

State: **Nebraska**
 County: **Antelope**
 Location: **1-26N-5W**
 Township: **Willow**
 Acres: **158.87**
 Date: **1/17/2026**



Maps Provided By:



Area Symbol: NE003, Soil Area Version: 27

Code	Soil Description	Acres	Percent of field	SRPG Legend	Non-Irr Class *c	Irr Class *c	SRPG	Grain sorghum Bu	Grain sorghum Irrigated Bu	*n NCCPI Overall	*n NCCPI Corn	*n NCCPI Small Grains	*n NCCPI Soybeans
6700	Thurman loamy fine sand, 0 to 2 percent slopes	87.16	55.0%		IIIe	IIIe	34			50	50	40	33
3264	O'Neill loam, 0 to 2 percent slopes	23.26	14.6%		IIc	IIs	42	40	120	45	45	45	36
4786	Valentine fine sand, 0 to 6 percent slopes	19.93	12.5%		VIe	IVe	24	2		30	29	30	22
6798	Loretto sandy loam, 0 to 3 percent slopes	15.80	9.9%		IIe	IIe	72	68	125	68	60	64	68
3164	Doger loamy fine sand, 0 to 2 percent slopes	9.49	6.0%		IIIe	IIIe	35	56	105	41	38	41	31
6508	Blendon fine sandy loam, 0 to 2 percent slopes	3.23	2.0%		IIs	IIe	46	59	107	64	64	54	56
Weighted Average					3.11	2.86	38	17.4	38.4	*n 48.3	*n 47.2	*n 42.2	*n 35.9

*n: The aggregation method is "Weighted Average using all components"

*c: Using Capabilities Class Dominant Condition Aggregation Method