

Soils Map

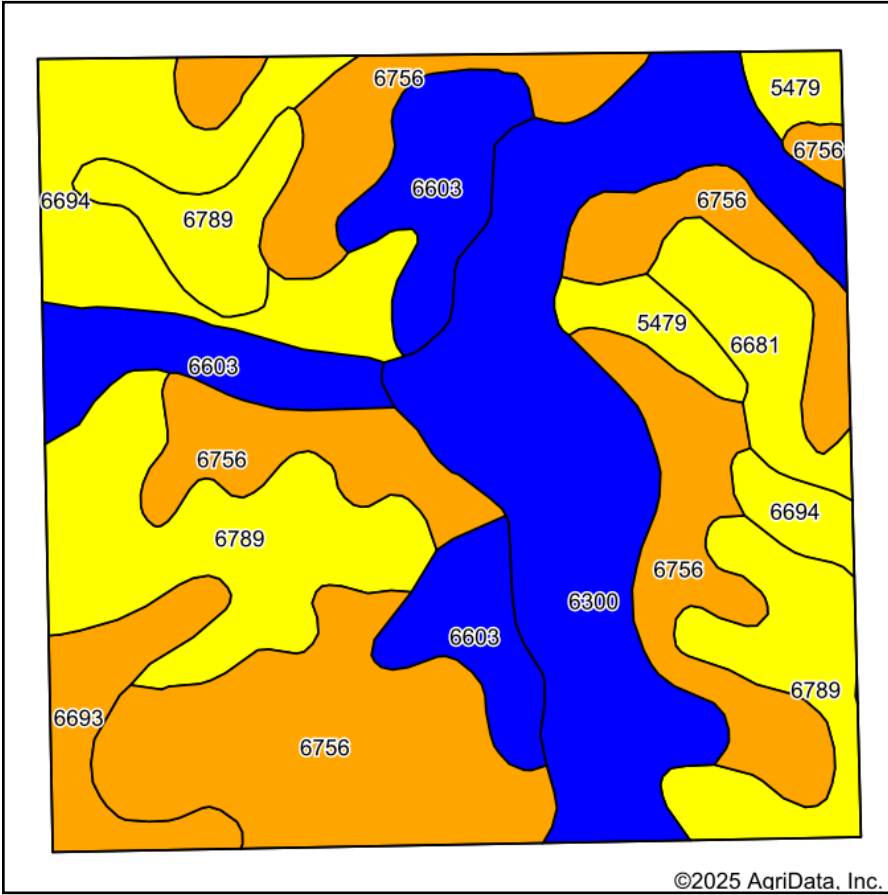

Soils data provided by USDA and NRCS.

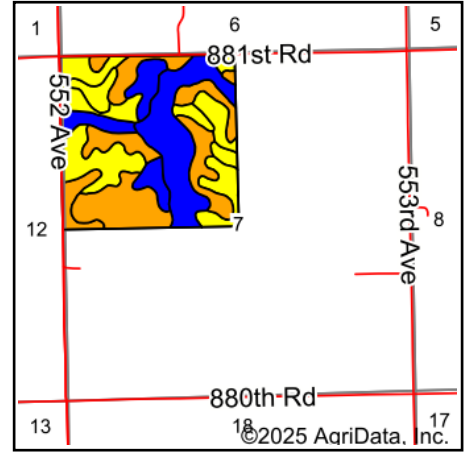

State: **Nebraska**
 County: **Cedar**
 Location: **7-30N-1W**
 Township: **Precinct 11**
 Acres: **163.56**
 Date: **10/24/2025**



| Area Symbol: NE027, Soil Area Version: 25 | | | | | | | | | | |
|---|---|-------|------------------|----------------------|------------------|--------------|------------------|----------------|-----------------------|-------------------|
| Code | Soil Description | Acres | Percent of field | Non-Irr Class Legend | Non-Irr Class *c | Irr Class *c | *n NCCPI Overall | *n NCCPI Corn | *n NCCPI Small Grains | *n NCCPI Soybeans |
| 6756 | Nora silt loam, 6 to 11 percent slopes, eroded | 51.02 | 31.2% | | IIle | IVe | 67 | 61 | 59 | 66 |
| 6300 | Aowa silt loam, 0 to 3 percent slopes, occasionally flooded | 33.00 | 20.2% | | IIw | IIw | 77 | 68 | 61 | 76 |
| 6789 | Crofton-Nora complex, 11 to 17 percent slopes, eroded | 29.26 | 17.9% | | Vle | | 61 | 57 | 54 | 61 |
| 6603 | Alcester silty clay loam, 2 to 6 percent slopes | 18.34 | 11.2% | | Ile | IIIe | 75 | 74 | 66 | 73 |
| 6694 | Crofton-Nora complex, 6 to 11 percent slopes, eroded | 15.61 | 9.5% | | IVe | IVe | 64 | 60 | 56 | 64 |
| 6693 | Crofton-Nora complex, 2 to 6 percent slopes, eroded | 6.02 | 3.7% | | IIIe | IIIe | 67 | 62 | 58 | 67 |
| 6681 | Crofton silt loam, 17 to 30 percent slopes, eroded | 5.82 | 3.6% | | Vle | | 38 | 38 | 31 | 36 |
| 5479 | Betts clay loam, 6 to 15 percent slopes | 4.49 | 2.7% | | IVe | IVe | 54 | 43 | 54 | 52 |
| Weighted Average | | | | | 3.45 | *- | *n 67.2 | *n 61.8 | *n 57.8 | *n 66.3 |

*n: The aggregation method is "Weighted Average using all components"

*c: Using Capabilities Class Dominant Condition Aggregation Method

*- Irr Class weighted average cannot be calculated on the current soils data due to missing data.