

Soils Map

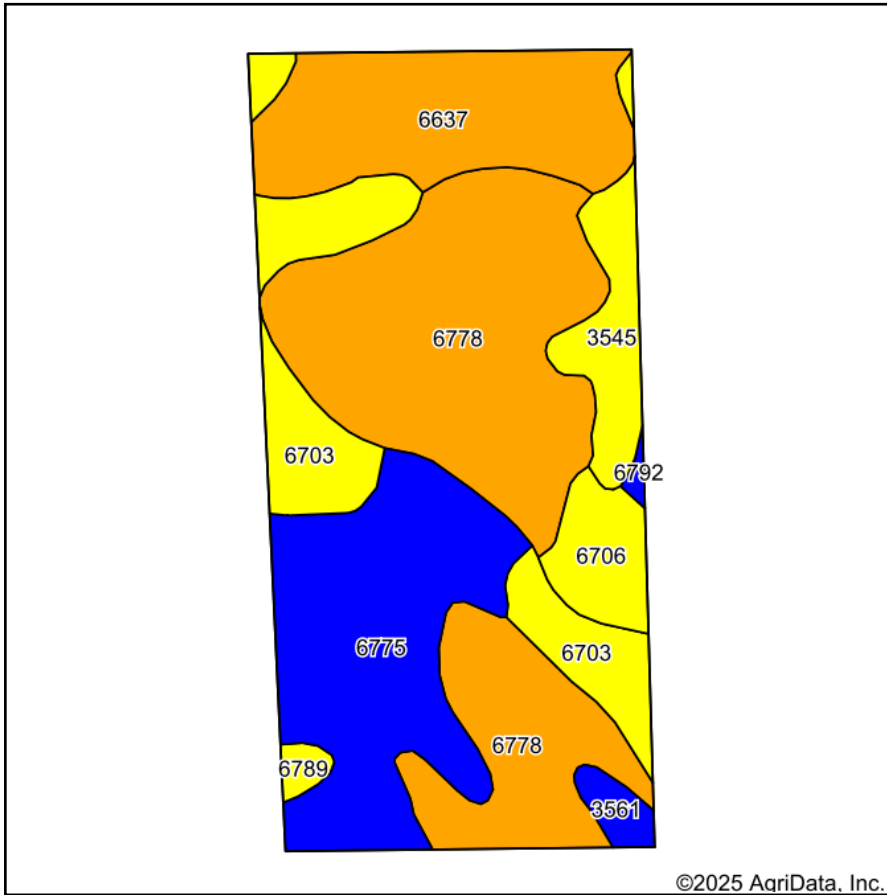

Soils data provided by USDA and NRCS.

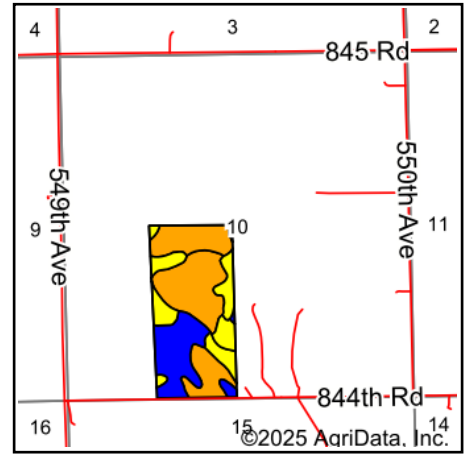

State: **Nebraska**
 County: **Madison**
 Location: **10-24N-2W**
 Township: **Valley**
 Acres: **75.07**
 Date: **10/7/2025**



Maps Provided By:



Area Symbol: NE119, Soil Area Version: 23

Code	Soil Description	Acres	Percent of field	Non-Irr Class Legend	Non-Irr Class *c	Irr Class *c	Grain sorghum Bu	Grain sorghum Irrigated Bu	*n NCCPI Overall	*n NCCPI Corn	*n NCCPI Small Grains	*n NCCPI Soybeans
6778	Nora-Crofton complex, 6 to 11 percent slopes, eroded	28.62	38.3%		IIIe	IVe			66	61	58	66
6775	Nora-Crofton complex, 2 to 6 percent slopes, eroded	16.39	21.8%		Ile	IIIe			68	62	59	68
6637	Boelus loamy fine sand, 2 to 6 percent slopes	11.72	15.6%		IIIe	IIIe			57	57	51	47
6703	Thurman loamy fine sand, 2 to 6 percent slopes	9.42	12.5%		IVe	IVe			51	51	41	34
3545	Hobbs silt loam, channeled, 0 to 2 percent slopes, frequently flooded	4.08	5.4%		VIw				41	41	26	39
6706	Thurman loamy fine sand, 6 to 11 percent slopes	3.07	4.1%		VIe	IVe			48	48	39	31
3561	Hobbs silt loam, 0 to 2 percent slopes, occasionally flooded, cool	1.00	1.3%		IIw	IIw			78	74	62	78

Soils data provided by USDA and NRCS.



Code	Soil Description	Acres	Percent of field	Non-Irr Class Legend	Non-Irr Class *c	Irr Class *c	Grain sorghum Bu	Grain sorghum Irrigated Bu	*n NCCPI Overall	*n NCCPI Corn	*n NCCPI Small Grains	*n NCCPI Soybeans
6789	Crofton-Nora complex, 11 to 17 percent slopes, eroded	0.56	0.7%		Ive				61	57	54	61
6792	Loretto loam, 2 to 6 percent slopes	0.21	0.3%		Ile	IIIe	83	120	66	63	66	66
Weighted Average					3.18	*-	0.2	0.3	*n 61.2	*n 57.9	*n 52.5	*n 56.7

*n: The aggregation method is "Weighted Average using all components"

*c: Using Capabilities Class Dominant Condition Aggregation Method

*- Irr Class weighted average cannot be calculated on the current soils data due to missing data.