

Aerial Map

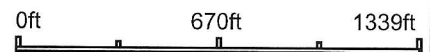

©2025 AgriData, Inc.

Boundary Center: 42° 12' 29.08, -97° 31' 1.6



Ag Land Realty, LLC

Real Estate Land Management Auctions

Maps Provided By:



© AgriData, Inc. 2023 www.AgriDataInc.com

23-26N-2W Pierce County Nebraska

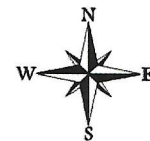

8/12/2025

Field borders provided by Farm Service Agency as of 5/21/2008.

Soils Map

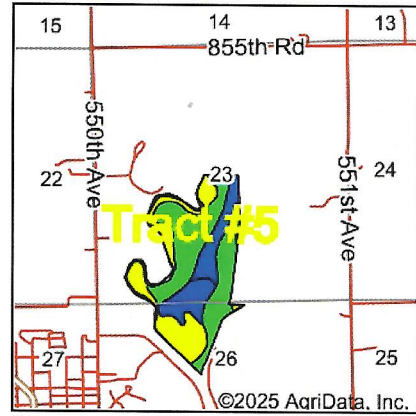
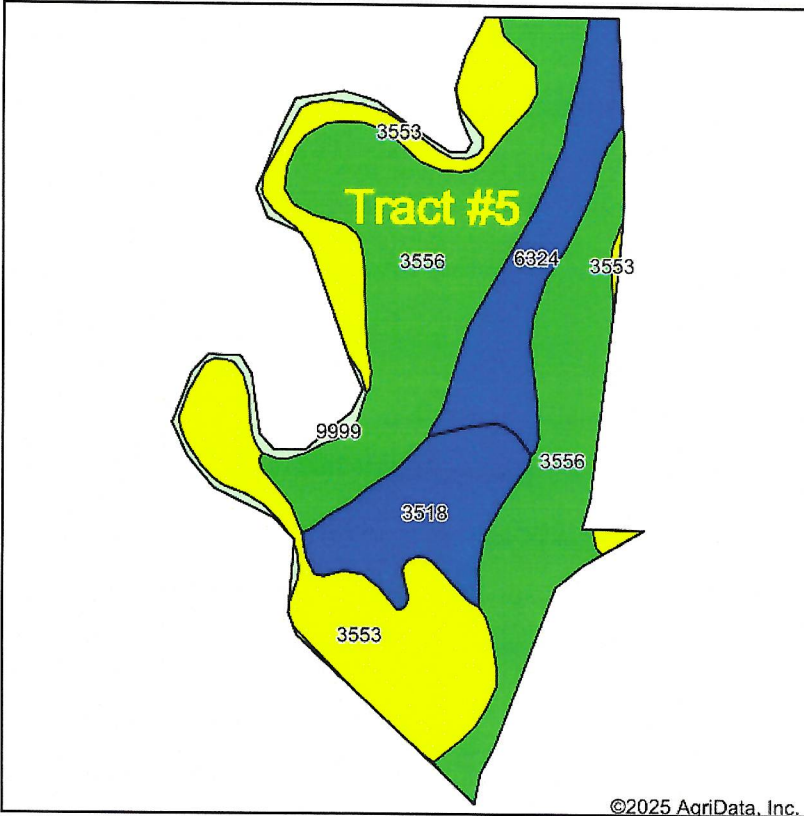

State: **Nebraska**
 County: **Pierce**
 Location: **23-26N-2W**
 Township: **Pierce**
 Acres: **124.39**
 Date: **8/12/2025**



Maps Provided By:



Soils data provided by USDA and NRCS.

©2025 AgriData, Inc.

Area Symbol: NE139, Soil Area Version: 23

Code	Soil Description	Acres	Percent of field	Non-Irr Class Legend	Non-Irr Class *c	Irr Class *c	*n NCCPI Overall	*n NCCPI Corn	*n NCCPI Small Grains	*n NCCPI Soybeans	
3556	Muir silt loam, calcareous, rarely flooded	59.18	47.5%		lw	lw	74	72	70	74	
3553	Hobbs silt loam, 0 to 2 percent slopes, frequently flooded, cool	33.17	26.7%		Vlw		58	57	49	54	
6324	Coleridge silty clay loam, 0 to 2 percent slopes, occasionally flooded	14.50	11.7%		llw	llw	80	79	57	74	
3518	Lamo silty clay loam, 0 to 2 percent slopes, occasionally flooded	13.70	11.0%		llw	llw	77	68	58	77	
9999	Water	3.84	3.1%								
Weighted Average						*-	*-	*n 68.5	*n 66.2	*n 59.4	*n 66.7

*n: The aggregation method is "Weighted Average using all components"

*c: Using Capabilities Class Dominant Condition Aggregation Method

*- Non Irr Class weighted average cannot be calculated on the current soils data due to missing data.

*- Irr Class weighted average cannot be calculated on the current soils data due to missing data.

Soils data provided by USDA and NRCS.