

Soils Map

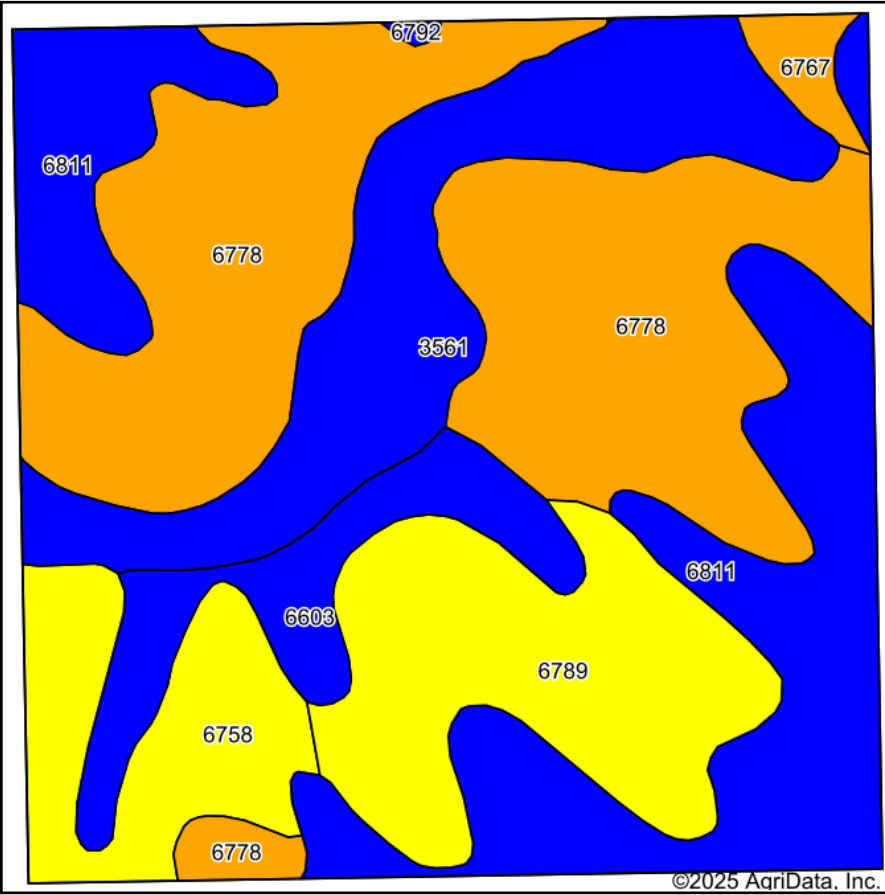

Soils data provided by USDA and NRCS.

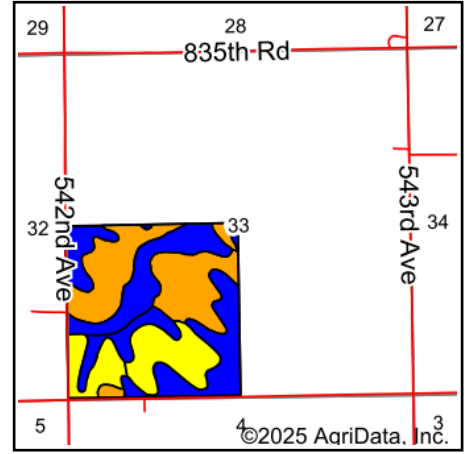

State: **Nebraska**
 County: **Madison**
 Location: **33-23N-3W**
 Township: **Highland**
 Acres: **159.63**
 Date: **8/22/2025**



Maps Provided By:



© AgriData, Inc. 2023

www.AgriDataInc.com



Area Symbol: NE119, Soil Area Version: 23

Code	Soil Description	Acres	Percent of field	Non-Irr Class Legend	Non-Irr Class *c	Irr Class *c	Grain sorghum Bu	Grain sorghum Irrigated Bu	*n NCCPI Overall	*n NCCPI Corn	*n NCCPI Small Grains	*n NCCPI Soybeans
6778	Nora-Crofton complex, 6 to 11 percent slopes, eroded	53.07	33.3%		IIIe	IVe			66	61	58	66
6811	Moody silty clay loam, 2 to 6 percent slopes	35.15	22.0%		Ile	IIIe			75	74	68	74
3561	Hobbs silt loam, 0 to 2 percent slopes, occasionally flooded, cool	23.77	14.9%		IIw	IIw			78	74	62	78
6789	Crofton-Nora complex, 11 to 17 percent slopes, eroded	22.35	14.0%		IVe				61	57	54	61
6758	Nora silty clay loam, 11 to 17 percent slopes	12.93	8.1%		IVe				69	60	59	69
6603	Alcester silty clay loam, 2 to 6 percent slopes	10.18	6.4%		Ile	IIIe			75	74	66	72
6767	Nora silty clay loam, 6 to 11 percent slopes	1.97	1.2%		IIIe	IVe			74	63	62	73
6792	Loretto loam, 2 to 6 percent slopes	0.21	0.1%		Ile	IIIe	83	120	66	63	66	66
Weighted Average					2.79	*-	0.1	0.2	*n 70	*n 66	*n 60.9	*n 69.6

Soils data provided by USDA and NRCS.

Maps Provided By:



© AgriData, Inc. 2023

www.AgriDataInc.com

*n: The aggregation method is "Weighted Average using all components"

*c: Using Capabilities Class Dominant Condition Aggregation Method

*- Irr Class weighted average cannot be calculated on the current soils data due to missing data.