

Soils Map

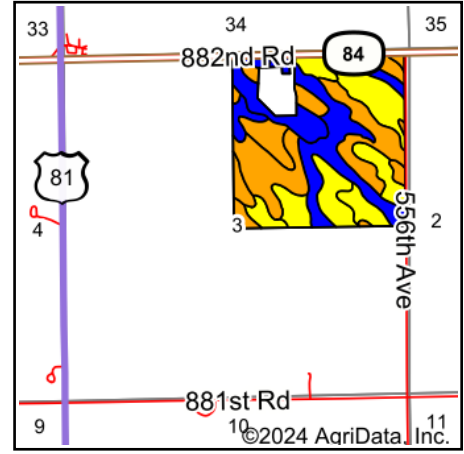

State: **Nebraska**
 County: **Cedar**
 Location: **3-30N-1W**
 Township: **Precinct 11**
 Acres: **150.48**
 Date: **12/17/2024**

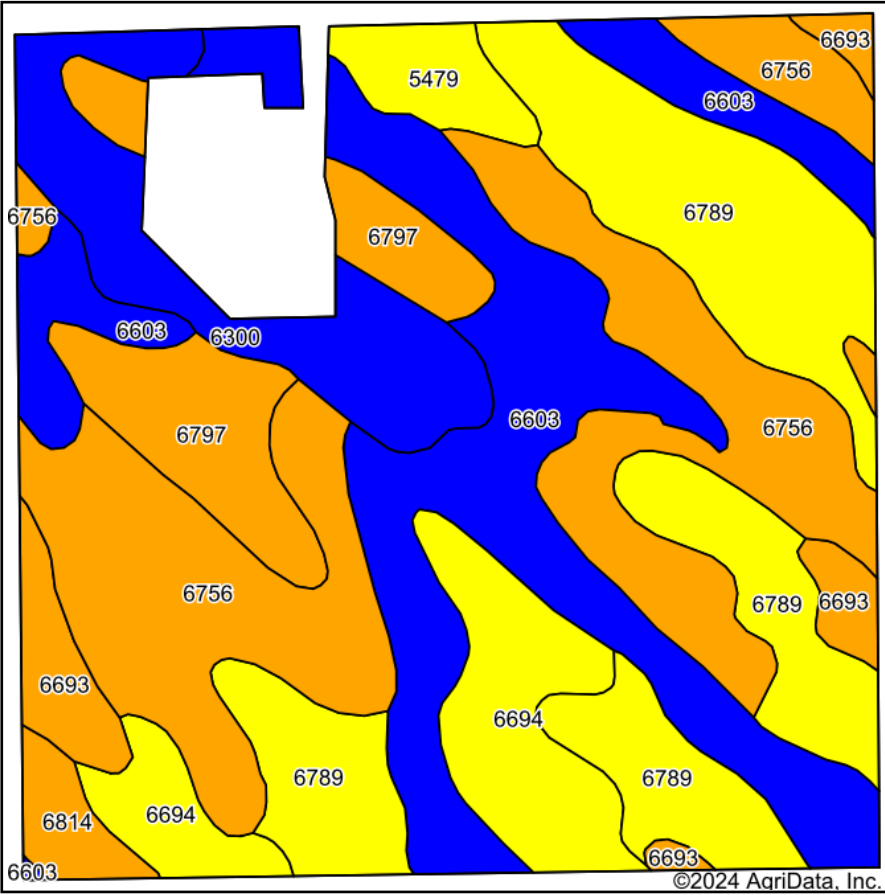

Maps Provided By:



Soils data provided by USDA and NRCS.

Area Symbol: NE027, Soil Area Version: 24

Code	Soil Description	Acres	Percent of field	Non-Irr Class Legend	Non-Irr Class *c	Irr Class *c	*n NCCPI Overall	*n NCCPI Corn	*n NCCPI Small Grains	*n NCCPI Soybeans
6756	Nora silt loam, 6 to 11 percent slopes, eroded	36.96	24.7%		IIIe	IVe	67	61	59	66
6603	Alcester silty clay loam, 2 to 6 percent slopes	33.71	22.4%		Ile	IIIe	75	74	66	72
6789	Crofton-Nora complex, 11 to 17 percent slopes, eroded	32.26	21.4%		IVe		61	57	54	61
6694	Crofton-Nora complex, 6 to 11 percent slopes, eroded	12.41	8.2%		IVe	IVe	64	60	56	64
6300	Aowa silt loam, 0 to 3 percent slopes, occasionally flooded	12.06	8.0%		IIw	IIw	77	68	61	76
6797	Loretto loam, sand substratum, 6 to 11 percent slopes	11.42	7.6%		IIIe	IVe	61	59	61	60
6693	Crofton-Nora complex, 2 to 6 percent slopes, eroded	5.81	3.9%		IIIe	IIIe	67	62	58	67
5479	Betts clay loam, 6 to 15 percent slopes	3.52	2.3%		IVe	IVe	54	43	54	52
6814	Moody silty clay loam, 6 to 11 percent slopes, eroded	2.33	1.5%		IIIe	IVe	63	62	57	61
Weighted Average					3.02	*-	*n 67.2	*n 63	*n 59.4	*n 66.1

*n: The aggregation method is "Weighted Average using all components"

*c: Using Capabilities Class Dominant Condition Aggregation Method

*- Irr Class weighted average cannot be calculated on the current soils data due to missing data.