

# Soils Map

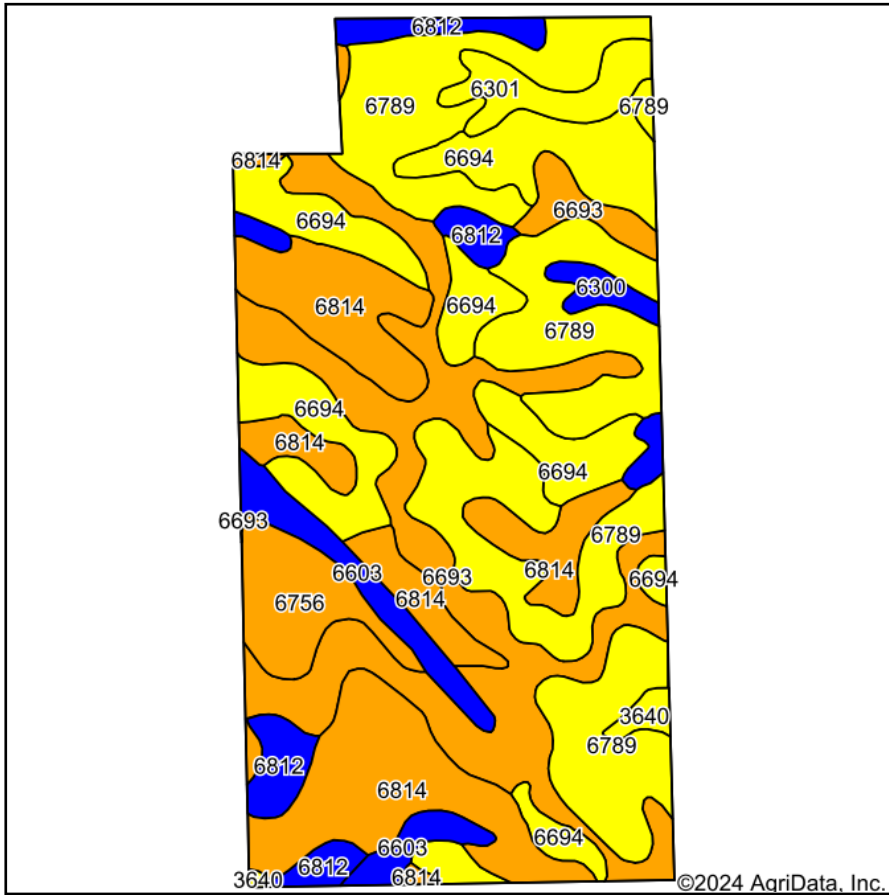

Soils data provided by USDA and NRCS.

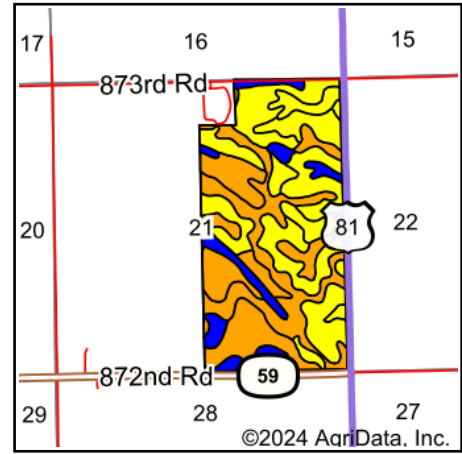

State: **Nebraska**  
 County: **Cedar**  
 Location: **21-29N-1W**  
 Township: **Precinct 18**  
 Acres: **292.43**  
 Date: **12/17/2024**



Maps Provided By:



© AgriData, Inc. 2023

www.AgriDataInc.com



Area Symbol: NE027, Soil Area Version: 24

Code	Soil Description	Acres	Percent of field	Non-Irr Class Legend	Non-Irr Class *c	Irr Class *c	*n NCCPI Overall	*n NCCPI Corn	*n NCCPI Small Grains	*n NCCPI Soybeans
6789	Crofton-Nora complex, 11 to 17 percent slopes, eroded	80.22	27.5%		IVe		61	57	54	61
6693	Crofton-Nora complex, 2 to 6 percent slopes, eroded	58.89	20.1%		IIIe	IIIe	67	62	58	67
6814	Moody silty clay loam, 6 to 11 percent slopes, eroded	56.24	19.2%		IIIe	IVe	63	62	57	61
6694	Crofton-Nora complex, 6 to 11 percent slopes, eroded	46.09	15.8%		IVe	IVe	64	60	56	64
6603	Alcester silty clay loam, 2 to 6 percent slopes	12.49	4.3%		Ile	IIIe	75	74	66	72
6812	Moody silty clay loam, 2 to 6 percent slopes, eroded	12.49	4.3%		Ile	IIIe	64	64	59	64
6756	Nora silt loam, 6 to 11 percent slopes, eroded	11.81	4.0%		IIIe	IVe	67	61	59	66
6301	Aowa silt loam, channeled, 0 to 3 percent slopes, frequently flooded	7.92	2.7%		VIw	VIw	52	44	30	52
6300	Aowa silt loam, 0 to 3 percent slopes, occasionally flooded	4.39	1.5%		IIw	IIw	77	68	61	76
3640	Kezan silt loam, 0 to 2 percent slopes, frequently flooded	1.89	0.6%		IVw		74	60	50	74
<b>Weighted Average</b>					<b>3.42</b>	<b>*-</b>	<b>*n 64.1</b>	<b>*n 60.5</b>	<b>*n 56.1</b>	<b>*n 63.5</b>

\*n: The aggregation method is "Weighted Average using all components"

\*c: Using Capabilities Class Dominant Condition Aggregation Method

\*- Irr Class weighted average cannot be calculated on the current soils data due to missing data.

Soils data provided by USDA and NRCS.