

Soils Map

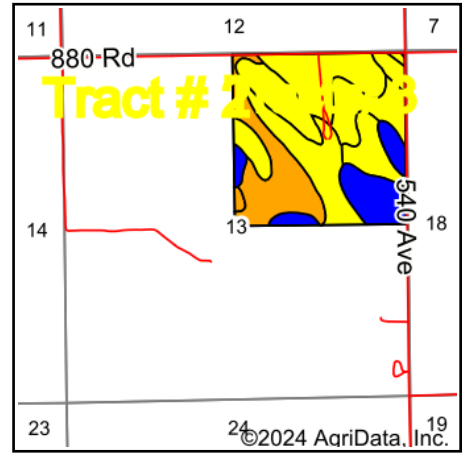

State: **Nebraska**
 County: **Knox**
 Location: **13-30N-4W**
 Township: **Central**
 Acres: **160.06**
 Date: **11/30/2024**

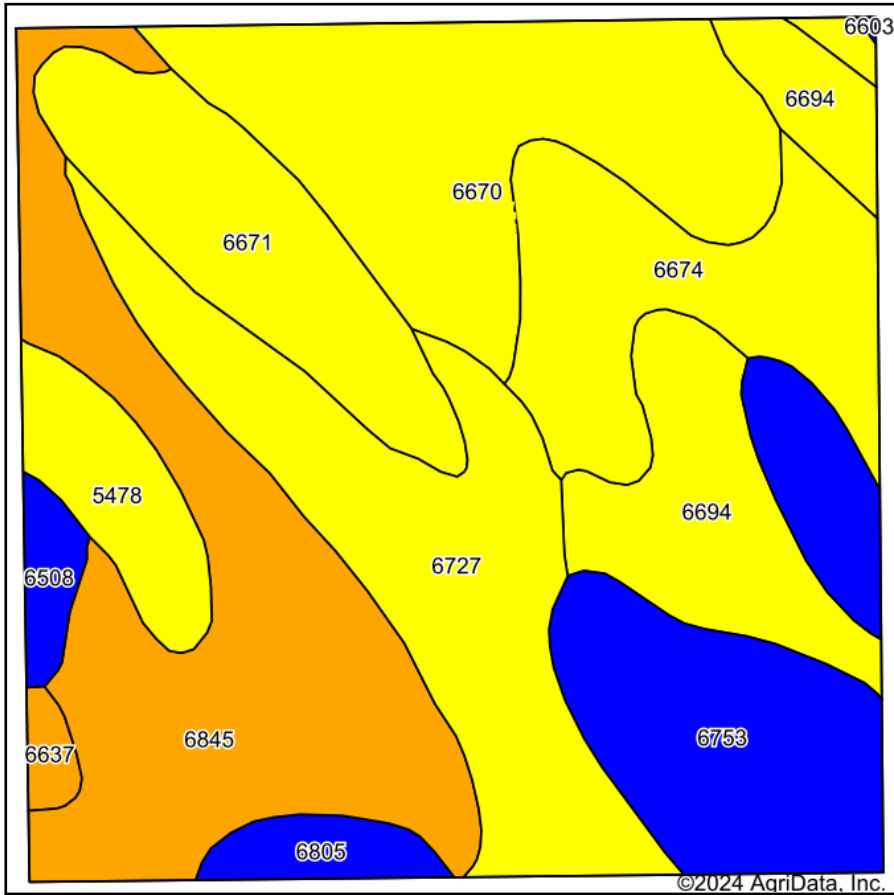

Soils data provided by USDA and NRCS.

Area Symbol: NE107, Soil Area Version: 22

| Code | Soil Description | Acres | Percent of field | Non-Irr Class Legend | Non-Irr Class *c | Irr Class *c | Grain sorghum Bu | Grain sorghum Irrigated Bu | *n NCCPI Overall | *n NCCPI Corn | *n NCCPI Small Grains | *n NCCPI Soybeans |
|------|---|-------|------------------|----------------------|------------------|--------------|------------------|----------------------------|------------------|---------------|-----------------------|-------------------|
| 6845 | Ortello fine sandy loam, 2 to 6 percent slopes | 31.51 | 19.6% | | IIle | IIle | | | 63 | 63 | 55 | 53 |
| 6670 | Crofton-Thurman complex, 11 to 17 percent slopes, eroded | 25.38 | 15.9% | | IVe | | | | 45 | 35 | 45 | 39 |
| 6727 | Thurman fine sandy loam, 2 to 11 percent slopes | 24.02 | 15.0% | | IVe | IVe | | | 43 | 34 | 43 | 31 |
| 6753 | Nora silt loam, 2 to 6 percent slopes | 19.94 | 12.5% | | IIe | IIIe | | | 75 | 65 | 63 | 75 |
| 6674 | Crofton silt loam, coarse, 8 to 17 percent slopes, eroded | 16.55 | 10.3% | | IVe | | | | 58 | 55 | 55 | 57 |
| 6694 | Crofton-Nora complex, 6 to 11 percent slopes, eroded | 15.08 | 9.4% | | IVe | IVe | | | 64 | 60 | 56 | 64 |
| 6671 | Crofton-Thurman complex, 17 to 30 percent slopes | 14.53 | 9.1% | | VIe | | | | 27 | 25 | 25 | 25 |
| 5478 | Betts clay loam, 6 to 11 percent slopes, eroded | 6.34 | 4.0% | | IVe | IVe | | | 50 | 35 | 50 | 46 |
| 6805 | Moody loam, 2 to 6 percent slopes | 2.81 | 1.8% | | IIe | IIIe | | | 78 | 78 | 67 | 74 |

Soils data provided by USDA and NRCS.



| Code | Soil Description | Acres | Percent of field | Non-Irr Class Legend | Non-Irr Class *c | Irr Class *c | Grain sorghum Bu | Grain sorghum Irrigated Bu | *n NCCPI Overall | *n NCCPI Corn | *n NCCPI Small Grains | *n NCCPI Soybeans |
|-------------------------|---|-------|------------------|----------------------|------------------|--------------|------------------|----------------------------|------------------|----------------|-----------------------|-------------------|
| 6508 | Blendon fine sandy loam, 0 to 2 percent slopes | 2.06 | 1.3% | | IIs | Ile | 59 | 107 | 64 | 64 | 54 | 56 |
| 6637 | Boelus loamy fine sand, 2 to 6 percent slopes | 1.14 | 0.7% | | IIle | IIIle | | | 57 | 57 | 51 | 47 |
| 6672 | Crofton-Thurman complex, 6 to 11 percent slopes, eroded | 0.64 | 0.4% | | IVe | IVe | | | 47 | 37 | 47 | 42 |
| 6603 | Alcester silty clay loam, 2 to 6 percent slopes | 0.06 | 0.0% | | Ile | IIIle | | | 75 | 74 | 66 | 72 |
| Weighted Average | | | | | 3.67 | *- | 0.8 | 1.4 | *n 54.6 | *n 48.9 | *n 49.9 | *n 49.2 |

*n: The aggregation method is "Weighted Average using all components"

*c: Using Capabilities Class Dominant Condition Aggregation Method

*- Irr Class weighted average cannot be calculated on the current soils data due to missing data.