

Soils Map

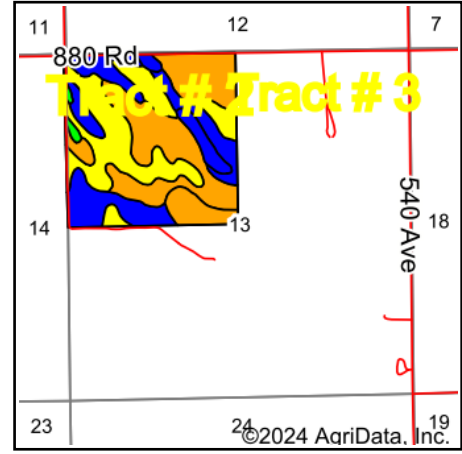

State: **Nebraska**
 County: **Knox**
 Location: **13-30N-4W**
 Township: **Central**
 Acres: **159.56**
 Date: **11/30/2024**

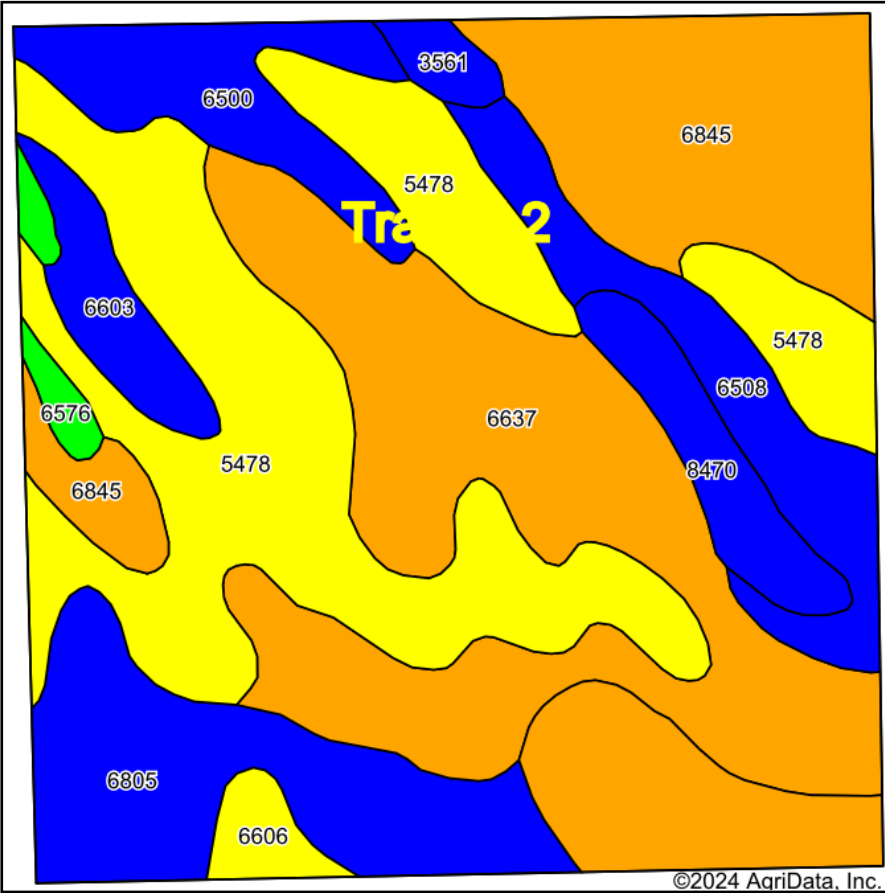

Soils data provided by USDA and NRCS.

Area Symbol: NE107, Soil Area Version: 22

Code	Soil Description	Acres	Percent of field	Non-Irr Class Legend	Non-Irr Class *c	Irr Class *c	Grain sorghum Bu	Grain sorghum Irrigated Bu	*n NCCPI Overall	*n NCCPI Corn	*n NCCPI Small Grains	*n NCCPI Soybeans
5478	Betts clay loam, 6 to 11 percent slopes, eroded	42.39	26.4%		IVe	IVe			50	35	50	46
6637	Boelus loamy fine sand, 2 to 6 percent slopes	36.34	22.8%		IIIe	IIIe			57	57	51	47
6845	Ortello fine sandy loam, 2 to 6 percent slopes	30.66	19.2%		IIIe	IIIe			63	63	55	53
6805	Moody loam, 2 to 6 percent slopes	16.41	10.3%		Ile	IIIe			78	78	67	74
6508	Blendon fine sandy loam, 0 to 2 percent slopes	10.16	6.4%		IIs	Ile	59	107	64	64	54	56
6500	Bazile loam, 0 to 2 percent slopes	8.55	5.4%		IIs	Ile			69	69	59	69
8470	Gibbon silt loam, 0 to 2 percent slopes, occasionally flooded	5.40	3.4%		IIw	IIw	88	113	81	64	52	81
6603	Alcester silty clay loam, 2 to 6 percent slopes	4.45	2.8%		Ile	IIIe			75	74	66	72
6606	Bazile loam, 6 to 11 percent slopes	2.03	1.3%		IVe	IVe			58	44	58	51
6576	Trent silt loam, moderately wet, 0 to 2 percent slopes	1.64	1.0%		Iw	Iw			68	51	68	68

Soils data provided by USDA and NRCS.



Code	Soil Description	Acres	Percent of field	Non-Irr Class Legend	Non-Irr Class *c	Irr Class *c	Grain sorghum Bu	Grain sorghum Irrigated Bu	*n NCCPI Overall	*n NCCPI Corn	*n NCCPI Small Grains	*n NCCPI Soybeans
3561	Hobbs silt loam, 0 to 2 percent slopes, occasionally flooded, cool	1.53	1.0%		llw	llw			78	74	62	78
Weighted Average					2.97	3.04	6.7	10.6	*n 61.2	*n 56.2	*n 54.6	*n 54.8

*n: The aggregation method is "Weighted Average using all components"

*c: Using Capabilities Class Dominant Condition Aggregation Method