

Soils Map

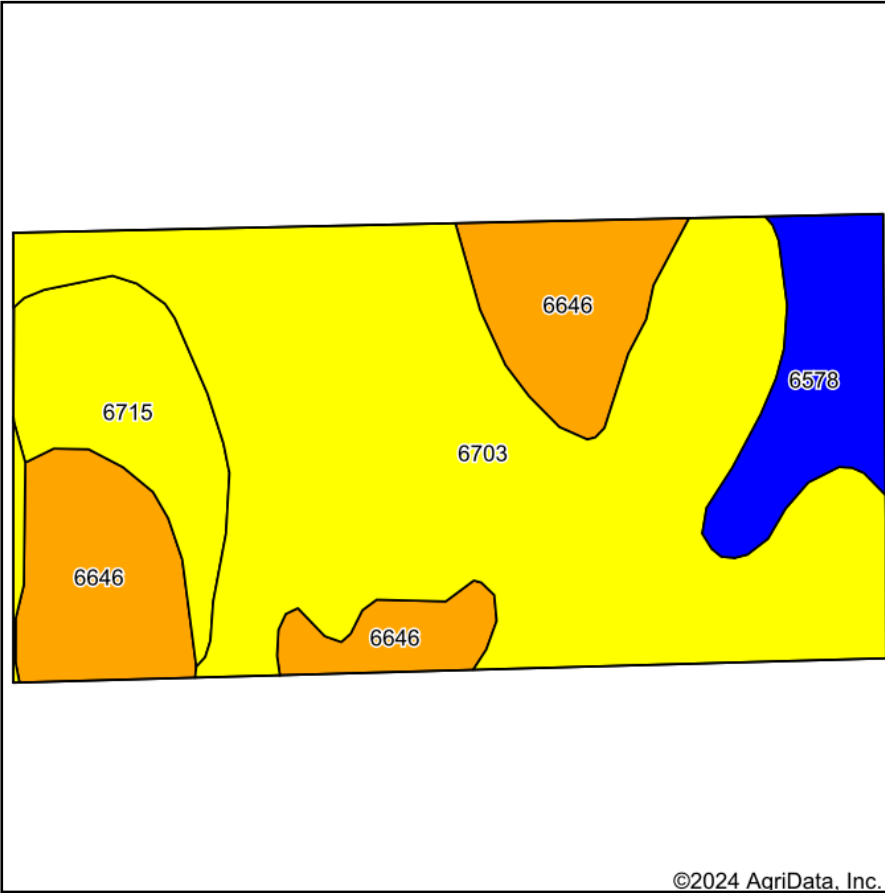

©2024 AgriData, Inc.

Soils data provided by USDA and NRCS.

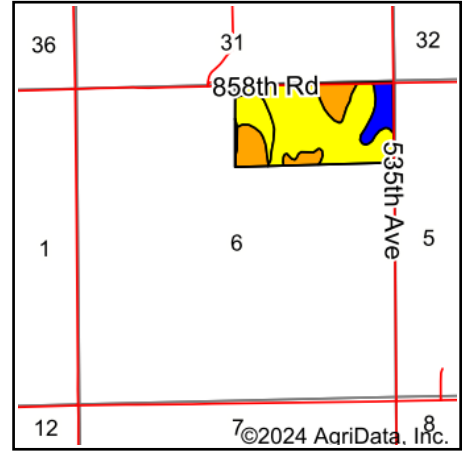

State: **Nebraska**
 County: **Pierce**
 Location: **6-26N-4W**
 Township: **Willow Creek**
 Acres: **81.77**
 Date: **10/16/2024**



Maps Provided By:



© AgriData, Inc. 2023

www.AgriDataInc.com



Area Symbol: NE139, Soil Area Version: 22

Code	Soil Description	Acres	Percent of field	Non-Irr Class Legend	Non-Irr Class *c	Irr Class *c	Grain sorghum Bu	Grain sorghum Irrigated Bu	*n NCCPI Overall	*n NCCPI Corn	*n NCCPI Small Grains	*n NCCPI Soybeans
6703	Thurman loamy fine sand, 2 to 6 percent slopes	49.32	60.4%	Yellow	IVe	IVe			51	51	41	34
6646	Boelus-Loretto complex, 0 to 2 percent slopes	16.63	20.3%	Orange	IIIe	IIIe			56	48	56	51
6715	Thurman-Valentine complex, undulating	8.44	10.3%	Yellow	IVe	IVe	25	93	33	31	33	25
6578	Ortello fine sandy loam, 0 to 2 percent slopes	7.38	9.0%	Blue	Ile	Ile			64	64	56	54
Weighted Average					3.62	3.62	2.6	9.6	*n 51.3	*n 49.5	*n 44.6	*n 38.3

*n: The aggregation method is "Weighted Average using all components"

*c: Using Capabilities Class Dominant Condition Aggregation Method

Soils data provided by USDA and NRCS.