

Soils Map

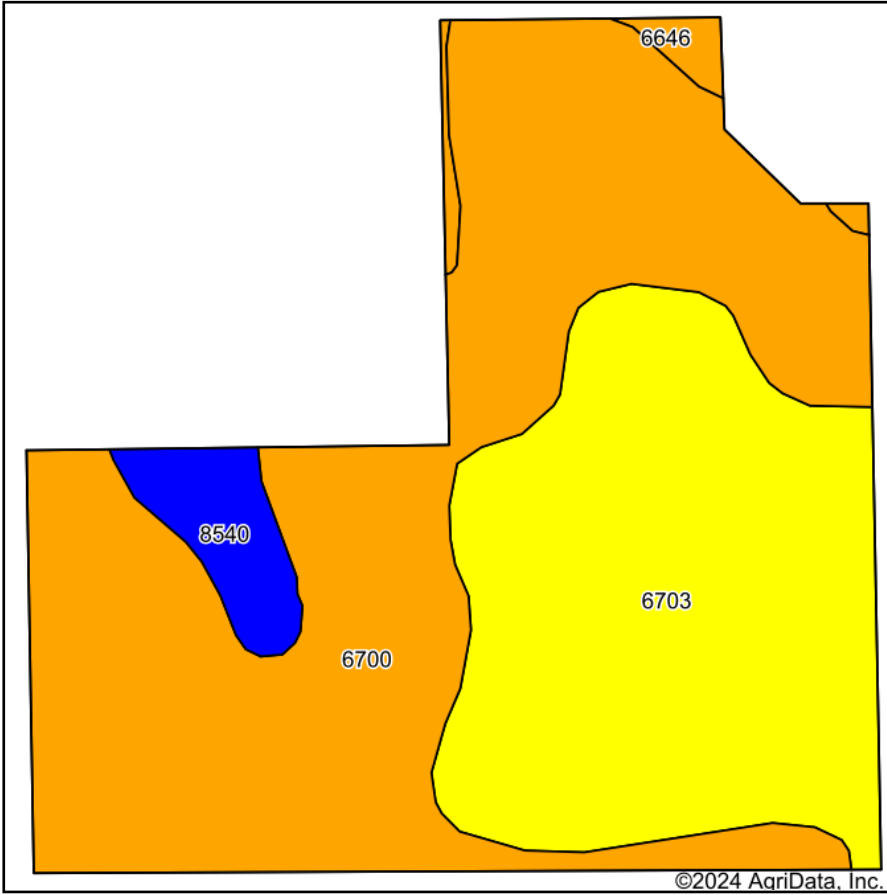

Soils data provided by USDA and NRCS.

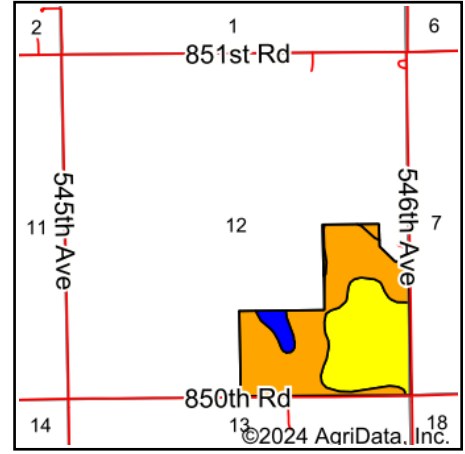

State: **Nebraska**
 County: **Pierce**
 Location: **12-25N-3W**
 Township: **Blaine**
 Acres: **113.05**
 Date: **3/26/2024**



Maps Provided By:



Area Symbol: NE139, Soil Area Version: 22

Code	Soil Description	Acres	Percent of field	Non-Irr Class Legend	Non-Irr Class *c	Irr Class *c	*n NCCPI Overall	*n NCCPI Corn	*n NCCPI Small Grains	*n NCCPI Soybeans
6700	Thurman loamy fine sand, 0 to 2 percent slopes	62.69	55.5%		IIIe	IIIe	50	50	40	33
6703	Thurman loamy fine sand, 2 to 6 percent slopes	44.17	39.1%		IVe	IVe	51	51	41	34
8540	Ovina fine sandy loam, rarely flooded	4.49	4.0%		IIw	IIw	60	48	54	60
6646	Boelus-Loretto complex, 0 to 2 percent slopes	1.70	1.5%		IIIe	IIIe	56	48	56	51
Weighted Average					3.35	3.35	*n 50.9	*n 50.3	*n 41.2	*n 34.7

*n: The aggregation method is "Weighted Average using all components"

*c: Using Capabilities Class Dominant Condition Aggregation Method