

# Soils Map

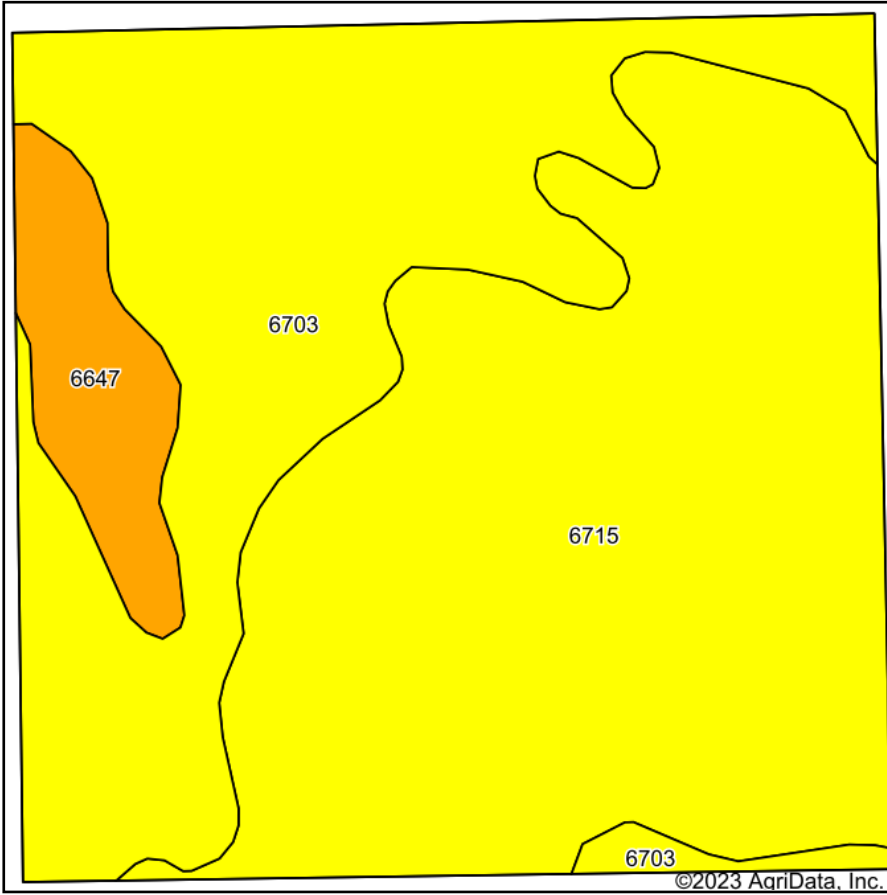

Soils data provided by USDA and NRCS.

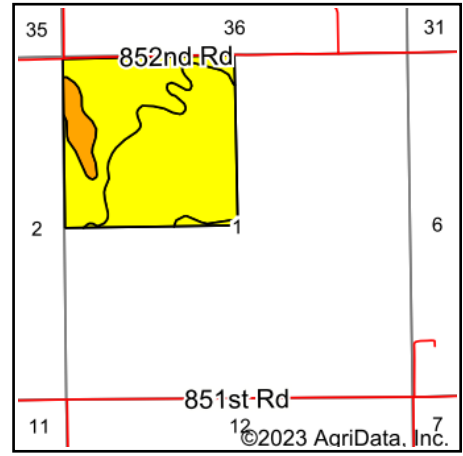

State: **Nebraska**  
 County: **Pierce**  
 Location: **1-25N-3W**  
 Township: **Blaine**  
 Acres: **156.66**  
 Date: **11/9/2023**



Maps Provided By:



© AgriData, Inc. 2023

www.AgriDataInc.com



Area Symbol: NE139, Soil Area Version: 22

Code	Soil Description	Acres	Percent of field	Non-Irr Class Legend	Non-Irr Class *c	Irr Class *c	Grain sorghum Bu	Grain sorghum Irrigated Bu	*n NCCPI Overall	*n NCCPI Corn	*n NCCPI Small Grains	*n NCCPI Soybeans
6715	Thurman-Valentine complex, undulating	86.36	55.1%		IVe	IVe	25	93	33	31	33	25
6703	Thurman loamy fine sand, 2 to 6 percent slopes	60.02	38.3%		IVe	IVe			51	51	41	34
6647	Boelus-Loretto complex, 2 to 6 percent slopes	10.28	6.6%		IIIe	IIIe			56	47	56	49
<b>Weighted Average</b>					<b>3.93</b>	<b>3.93</b>	<b>13.8</b>	<b>51.3</b>	<b>*n 41.4</b>	<b>*n 39.7</b>	<b>*n 37.6</b>	<b>*n 30</b>

\*n: The aggregation method is "Weighted Average using all components"

\*c: Using Capabilities Class Dominant Condition Aggregation Method

Soils data provided by USDA and NRCS.