

# Soils Map

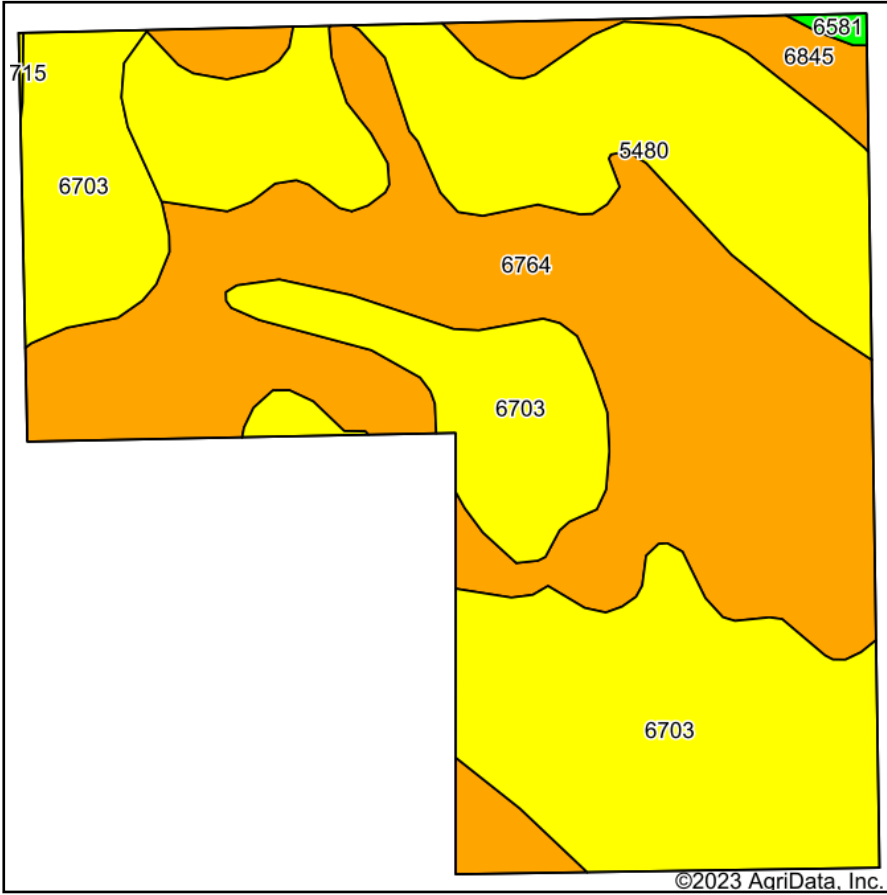

Soils data provided by USDA and NRCS.

©2023 AgriData, Inc.

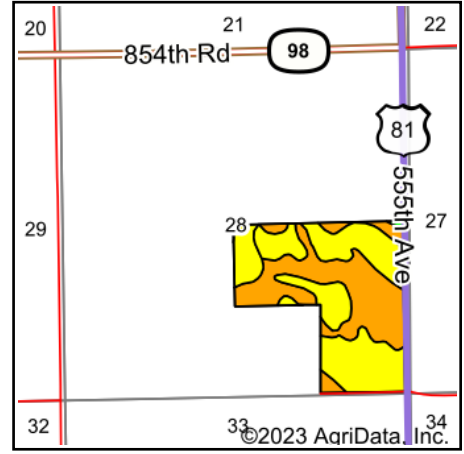

State: **Nebraska**  
 County: **Pierce**  
 Location: **28-26N-1W**  
 Township: **Slough**  
 Acres: **113.37**  
 Date: **11/14/2023**



Maps Provided By:



© AgriData, Inc. 2023

www.AgriDataInc.com



Area Symbol: NE139, Soil Area Version: 22

Code	Soil Description	Acres	Percent of field	Non-Irr Class Legend	Non-Irr Class *c	Irr Class *c	Grain sorghum Bu	Grain sorghum Irrigated Bu	*n NCCPI Overall	*n NCCPI Corn	*n NCCPI Small Grains	*n NCCPI Soybeans
6764	Hadar loamy fine sand, 2 to 6 percent slopes	44.52	39.3%		IIIe	IIIe	4	5	59	59	51	51
6703	Thurman loamy fine sand, 2 to 6 percent slopes	39.33	34.7%		IVe	IVe			51	51	41	34
5480	Betts loam, 3 to 11 percent slopes, eroded	24.50	21.6%		IVe	IVe			48	41	47	48
6845	Ortello fine sandy loam, 2 to 6 percent slopes	4.63	4.1%		IIIe	IIIe			63	63	55	53
6581	Ortello loam, terrace, 0 to 1 percent slopes	0.33	0.3%		I	I			58	49	58	48
6715	Thurman-Valentine complex, undulating	0.06	0.1%		IVe	IVe	25	93	33	31	33	25
<b>Weighted Average</b>					<b>3.56</b>	<b>3.56</b>	<b>1.6</b>	<b>2</b>	<b>*n 54</b>	<b>*n 52.5</b>	<b>*n 46.8</b>	<b>*n 44.5</b>

\*n: The aggregation method is "Weighted Average using all components"

\*c: Using Capabilities Class Dominant Condition Aggregation Method

Soils data provided by USDA and NRCS.