

# Soils Map

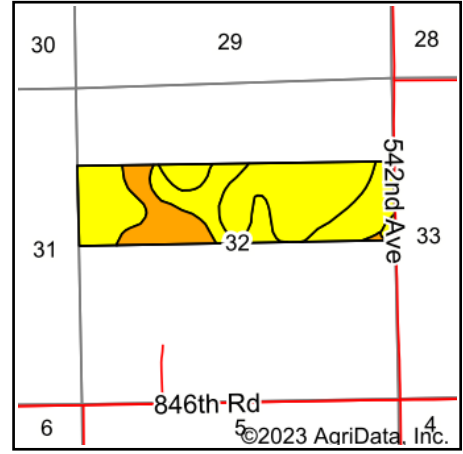

State: **Nebraska**  
 County: **Pierce**  
 Location: **32-25N-3W**  
 Township: **Blaine**  
 Acres: **159.96**  
 Date: **3/24/2023**

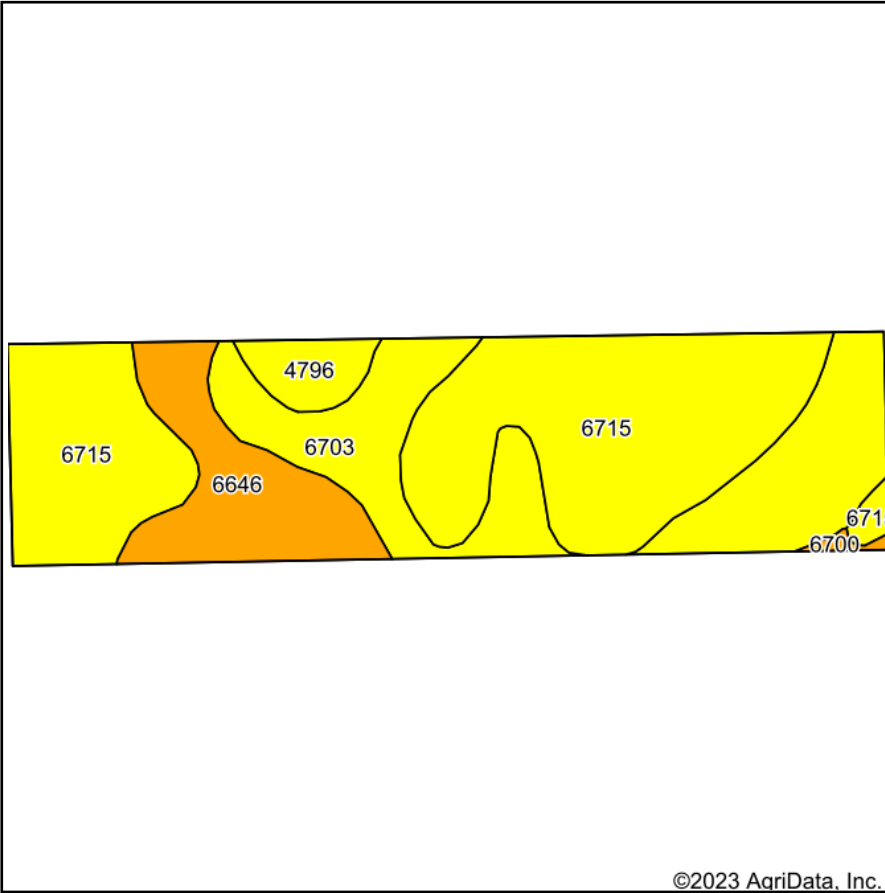

Soils data provided by USDA and NRCS.

Area Symbol: NE139, Soil Area Version: 21

Code	Soil Description	Acres	Percent of field	Non-Irr Class Legend	Non-Irr Class *c	Irr Class *c	Grain sorghum Bu	Grain sorghum Irrigated Bu	*n NCCPI Overall	*n NCCPI Corn	*n NCCPI Small Grains	*n NCCPI Soybeans
6715	Thurman-Valentine complex, undulating	82.69	51.7%		IVe	IVe	25	93	23	22	20	23
6703	Thurman loamy fine sand, 2 to 6 percent slopes	47.14	29.5%		IVe	IVe			35	35	27	34
6646	Boelus-Loretto complex, 0 to 2 percent slopes	23.10	14.4%		IIIe	IIIe			51	48	44	51
4796	Valentine fine sand, rolling, moist	6.25	3.9%		VIe				22	22	19	22
6700	Thurman loamy fine sand, 0 to 2 percent slopes	0.78	0.5%		IIIe	IIIe			33	33	26	33
<b>Weighted Average</b>					<b>3.93</b>	<b>*-</b>	<b>12.9</b>	<b>48.1</b>	<b>*n 30.6</b>	<b>*n 29.6</b>	<b>*n 25.5</b>	<b>*n 30.3</b>

\*n: The aggregation method is "Weighted Average using all components"

\*c: Using Capabilities Class Dominant Condition Aggregation Method

\*-: Irr Class weighted average cannot be calculated on the current soils data due to missing data.

Soils data provided by USDA and NRCS.