

# Soils Map

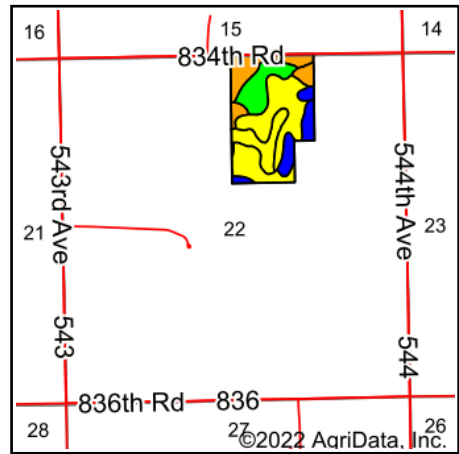

State: **Nebraska**  
 County: **Madison**  
 Location: **22-23N-3W**  
 Township: **Highland**  
 Acres: **53.11**  
 Date: **10/17/2022**

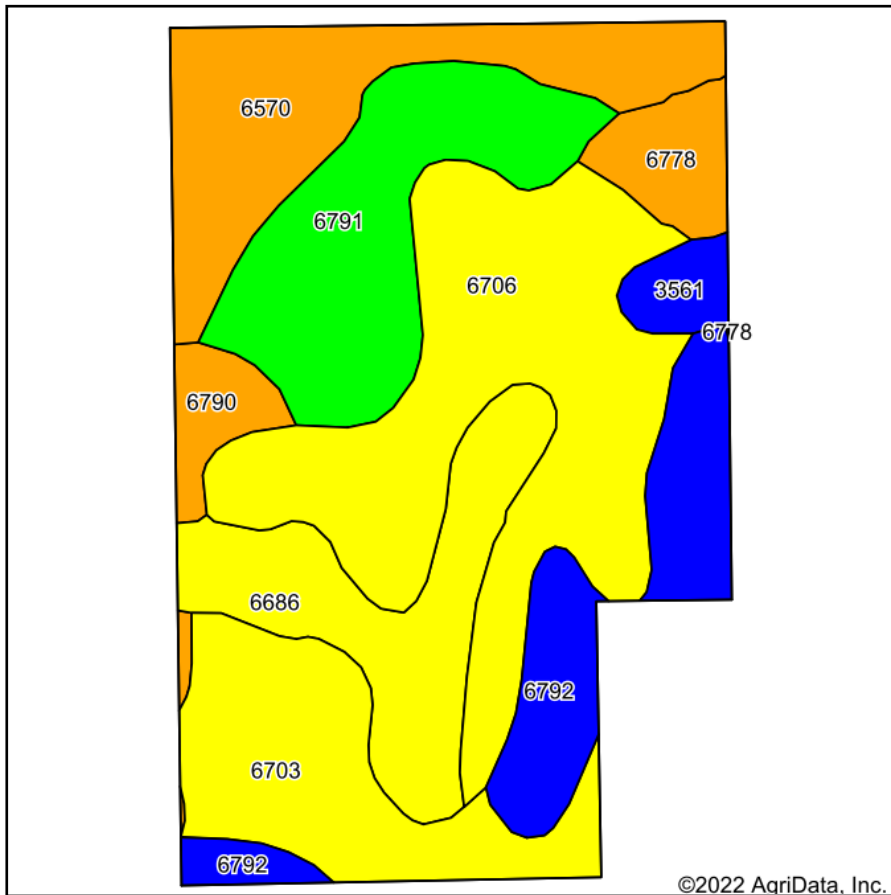

Soils data provided by USDA and NRCS.

Area Symbol: NE119, Soil Area Version: 20

Code	Soil Description	Acres	Percent of field	Non-Irr Class Legend	Non-Irr Class *c	Irr Class *c	Grain sorghum Bu	Grain sorghum Irrigated Bu	*n NCCPI Overall	*n NCCPI Corn	*n NCCPI Small Grains	*n NCCPI Soybeans
6706	Thurman loamy fine sand, 6 to 11 percent slopes	14.48	27.3%		VIe	IVe			48	48	33	31
6791	Loretto loam, 0 to 2 percent slopes	7.90	14.9%		I	I	92	125	67	64	55	67
6570	Thurman loamy fine sand, terrace, 0 to 2 percent slopes	7.32	13.8%		IIIe	IIIe			49	49	33	31
6703	Thurman loamy fine sand, 2 to 6 percent slopes	6.98	13.1%		IVe	IVe			51	51	35	34
6686	Crofton silt loam, 30 to 60 percent slopes	6.46	12.2%		VIIe				20	20	14	15
6792	Loretto loam, 2 to 6 percent slopes	5.53	10.4%		IIe	IIIe	83	120	66	64	55	66
6778	Nora-Crofton complex, 6 to 11 percent slopes, eroded	1.86	3.5%		IIIe	IVe			69	64	43	69
6790	Loretto fine sandy loam, 2 to 6 percent slopes	1.54	2.9%		IIIe	IIIe	78	118	62	57	51	62
3561	Hobbs silt loam, 0 to 2 percent slopes, occasionally flooded, cool	1.04	2.0%		IIw	IIw			79	75	49	79
<b>Weighted Average</b>					<b>4.01</b>	<b>*</b>	<b>24.6</b>	<b>34.5</b>	<b>*n 51.6</b>	<b>*n 50.5</b>	<b>*n 37.7</b>	<b>*n 41.6</b>

\*n: The aggregation method is "Weighted Average using all components"

\*c: Using Capabilities Class Dominant Condition Aggregation Method

\*- Irr Class weighted average cannot be calculated on the current soils data due to missing data.

Soils data provided by USDA and NRCS.