

Soils Map

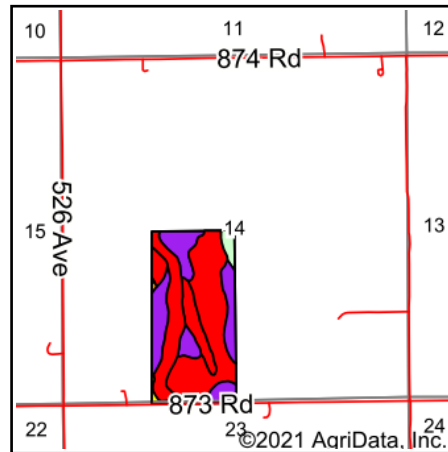

State: **Nebraska**
 County: **Knox**
 Location: **14-29N-6W**
 Township: **Miller**
 Acres: **78.38**
 Date: **11/26/2021**

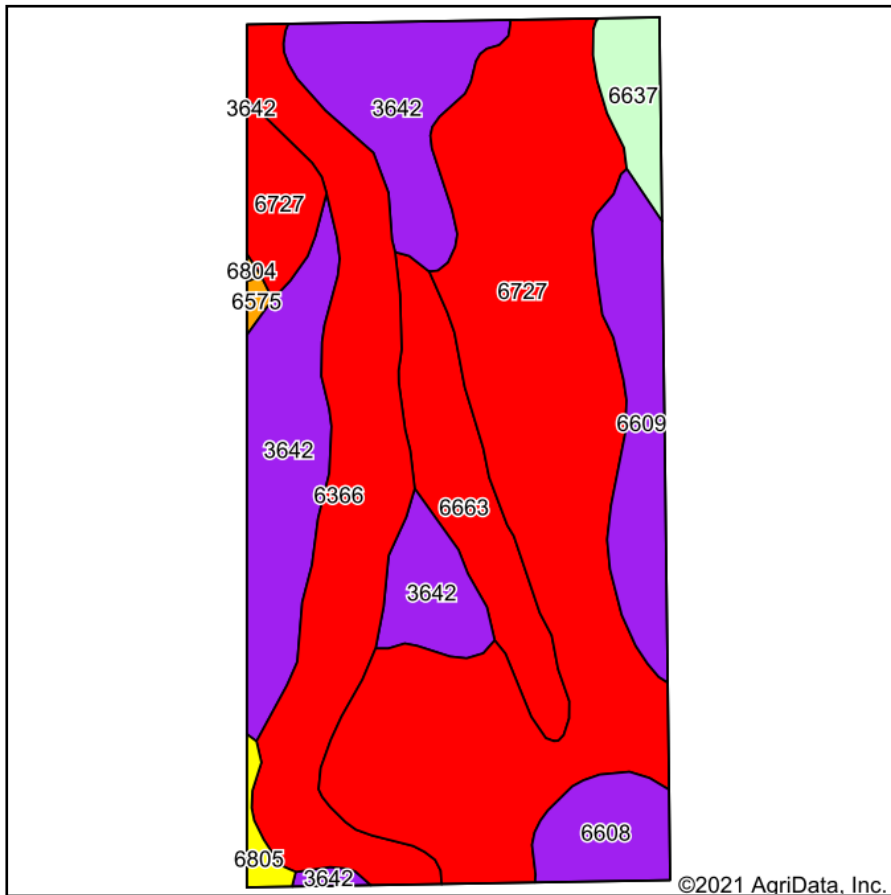

Soils data provided by USDA and NRCS.

Area Symbol: NE107, Soil Area Version: 19

Code	Soil Description	Acres	Percent of field	SRPG Legend	Non-Irr Class *c	Irr Class *c	Range Production (lbs/acre/yr)	SRPG	Alfalfa hay Tons	Alfalfa hay Irrigated Tons	Corn Bu	Corn Irrigated Bu	Oats Bu	Smooth brome grass AUM	Soybeans Bu	Soybeans Irrigated Bu
6727	Thurman fine sandy loam, 2 to 11 percent slopes	32.52	41.5%		Ive	Ive	3300	35	2	5	35	130	38	2	20	35
3642	Kezan silt loam, occasionally flooded	15.30	19.5%		Vw		4558	59			6	10	4	4	2	3
6366	Obert silt loam, occasionally flooded	13.79	17.6%		Vlw		5113	23			2				1	
6663	Brunswick-Paka complex, 17 to 30 percent slopes	5.87	7.5%		Vle		3000	19								
6609	Bazile loamy fine sand, 2 to 6 percent slopes	5.31	6.8%		Ille	Ille	2700	56	2	5	50	145	48	3	24	40
6608	Bazile loamy fine sand, 0 to 2 percent slopes	2.82	3.6%		Ille	Ile	2700	57	3	6	55	150	54	3	26	42
6637	Boelus loamy fine sand, 2 to 6 percent slopes	2.01	2.6%		Ille	Ille	3040									
6805	Moody loam, 2 to 6 percent slopes	0.57	0.7%		Ile	Ille	3600	69	3	6	70	150	65	3	30	45



6575	Trent silt loam, 0 to 2 percent slopes	0.19	0.2%				3208	72										
Weighted Average							4.55	2.04	3775.1	38	1.1	2.7	21.9	72.2	22.2	1.9	11.6	19.

*n: The aggregation method is "Weighted Average using all components"

*c: Using Capabilities Class Dominant Condition Aggregation Method

Soils data provided by USDA and NRCS.